

DATE CODE: 18101 (YYWWD)  
 YY: YEAR (2018)  
 WW: WEEK (01~52)  
 D: DAY (1~7)

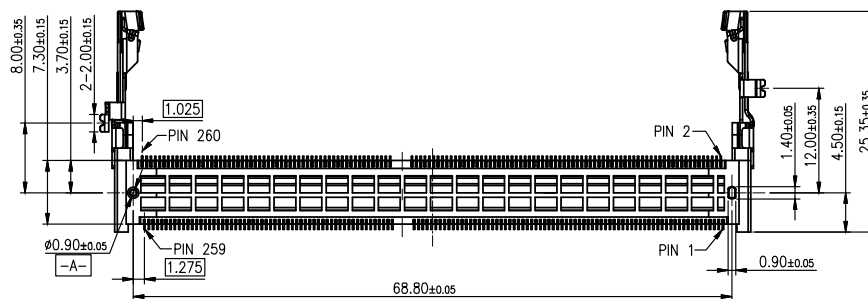
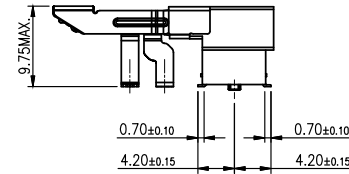
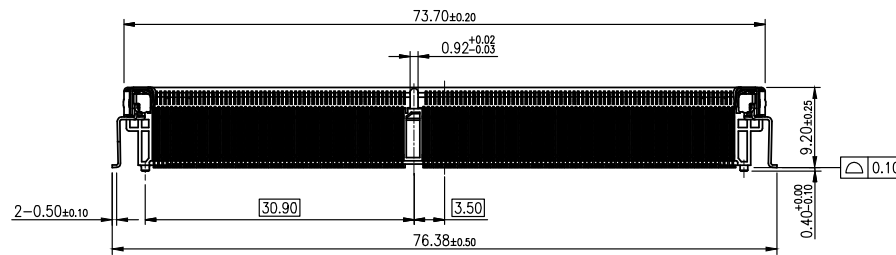
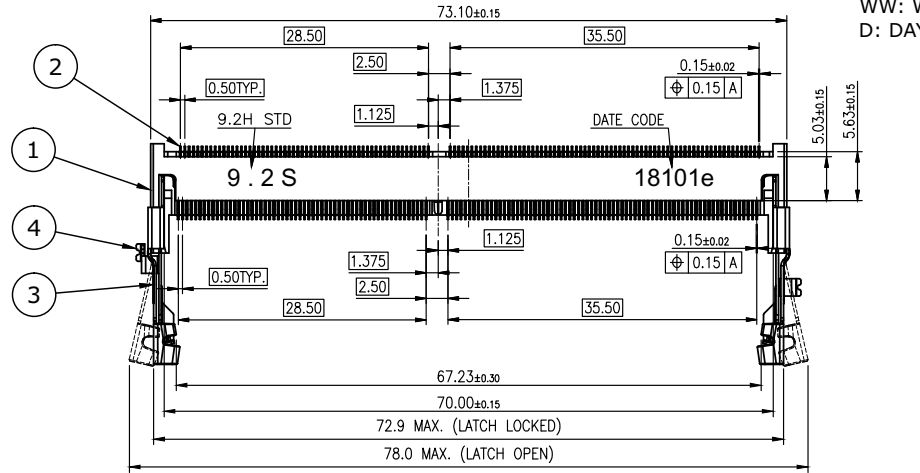

**SPECIFICATION:**

1. ELECTRICAL
  - 1.1 Current Rating: 0.6A per pin
  - 1.2 Voltage Rating: 25V AC
  - 1.3 Contact Resistance: 60mΩ max.
  - 1.4 Insulation Resistance: 100MΩ
  - 1.5 Dielectric Withstanding Voltage: 500VAC
2. MECHANICAL
  - 2.1 Durability: 50 Cycle
  - 2.2 Insertion Force: 59.8N max.
  - 2.3 Extraction Force: 44.6N max.
3. ENVIRONMENTAL
  - 3.1 Operating temperature range: -40°C~+85°C
  - 3.2 Storage temperature range: -40°C~+85°C
4. SOLDER ABILITY
  - 4.1 Recommended IR-Reflow Temperature: 260°C

4	PEG	Stainless steel, 50u" min. tin plating over 50u" min. nickel plating
3	LATCH	Stainless steel
2	CONTACT	Copper alloy, contact area gold flash, solder area gold flash, under plating 50u" min. nickel
1	HOUSING	LCP, UL94V-0, black
NO.	PART NAME	DESCRIPTION

**RoHS Compliant**

TOLERANCES ARE

**MORETHANALL**  
 PCB CONNECTORS  
 Cable ASSEMBLIES

煜倫股份有限公司

www.morethanall.com

DRAWING BY CY

CHECKED BY GENIUS

UNIT / mm SCALE 1 : 1

DATE

SIZE A4

X, ±  
 .X ±  
 .XX ±  
 .XXX ±  
 ANG ±

PJECTION

照片框

**ORDER INFORMATION**

SDM5-W92V12-144116-LF

SERIES | | | LEADFREE  
 | | | 144+116 WAY  
 | | | 12V  
 | | | HIGH 9.2mm  
 | | | 90°SMT

DESCRIPTION: DDR4 SODIMM Socket, Horizontal 9.2H, STD, G/F, Black, Reel, Solder PEG

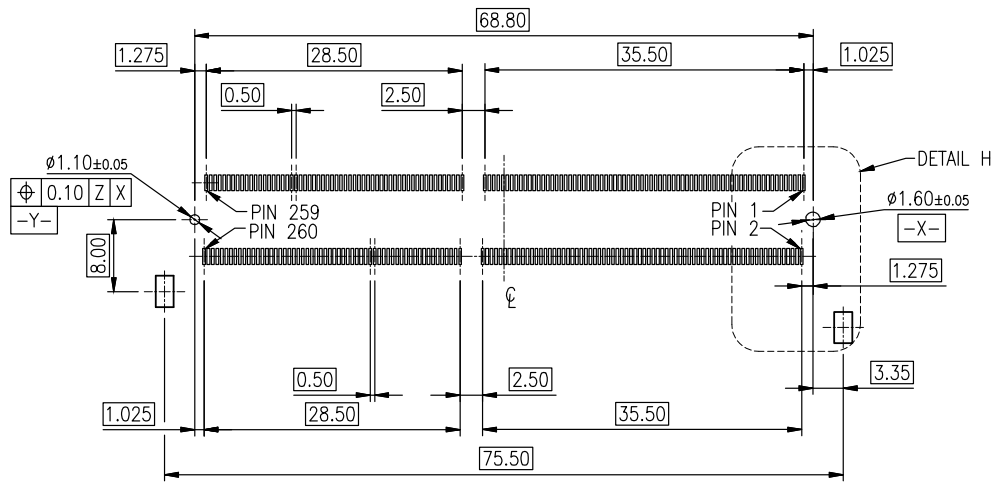

RECOMMENDED LAYOUT (TOP VIEW)

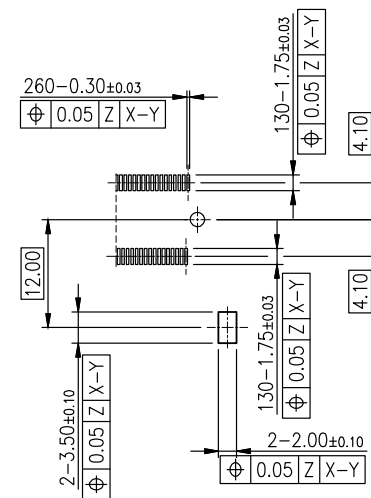

DETAIL H  
SCALE 1.6/1

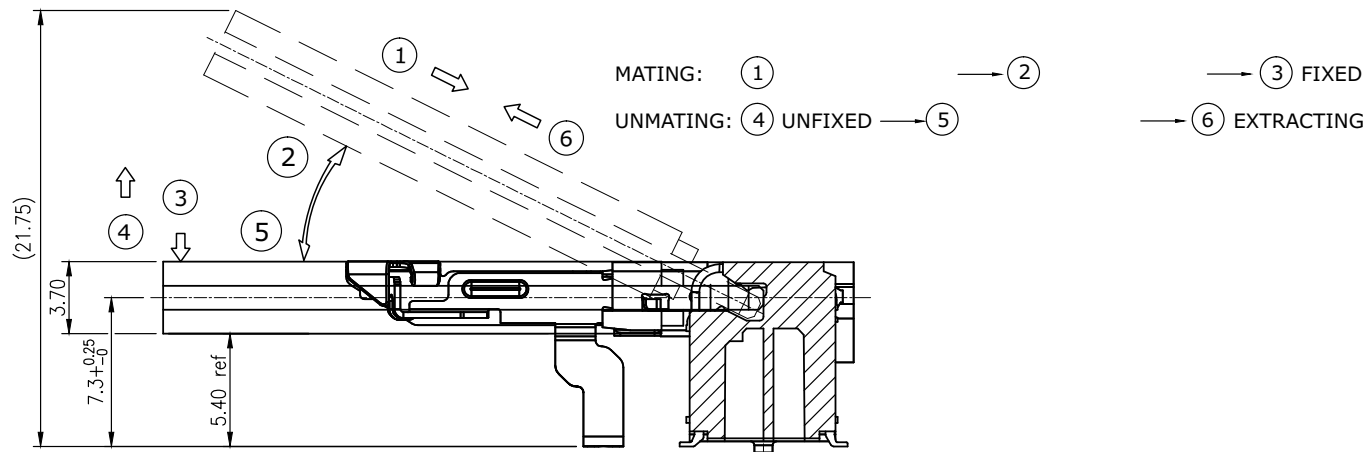

MATING/UNMATING VIEW

MATING: ① → ②  
UNMATING: ④ UNFIXED → ⑤  
③ FIXED  
⑥ EXTRACTING

RoHS Compliant

TOLERANCES ARE

**MORETHANALL**  
PCB CONNECTORS  
Cable ASSEMBLIES

DRAWING BY CY  
CHECKED BY GENIUS  
UNIT / mm SCALE 1 : 1  
DATE

X. ±  
.X ±  
.XX ±  
.XXX ±  
ANG ±

照片框

ORDER INFORMATION

SDM5-W92V12-144116-LF

SERIES | | | | LEADFREE  
| | | | 144+116 WAY  
| | | | 12V  
| | | | HIGH 9.2mm  
| | | | 90°SMT

煜倫股份有限公司

www.morethanall.com

SIZE A4 PPROJECTION

DESCRIPTION: DDR4 SODIMM Socket, Horizontal 9.2H, STD, G/F, Black, Reel, Solder PEG

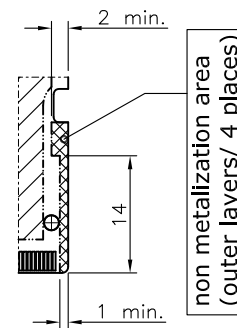
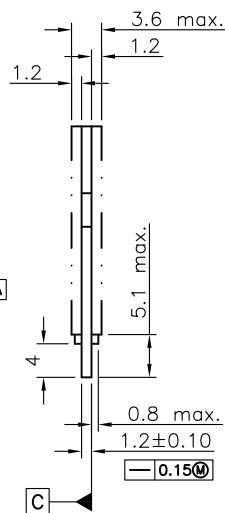
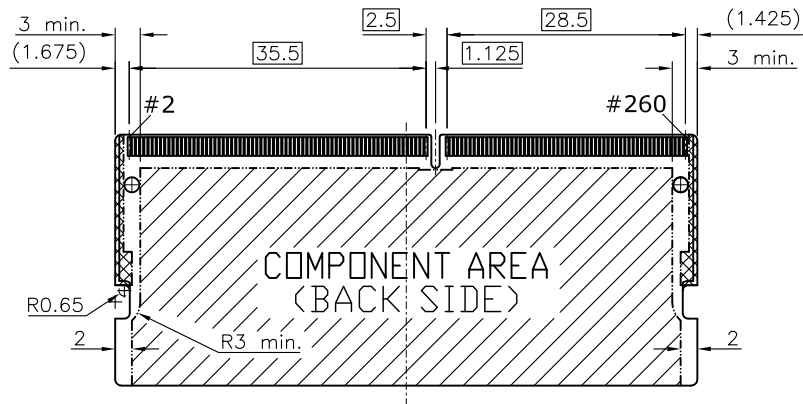
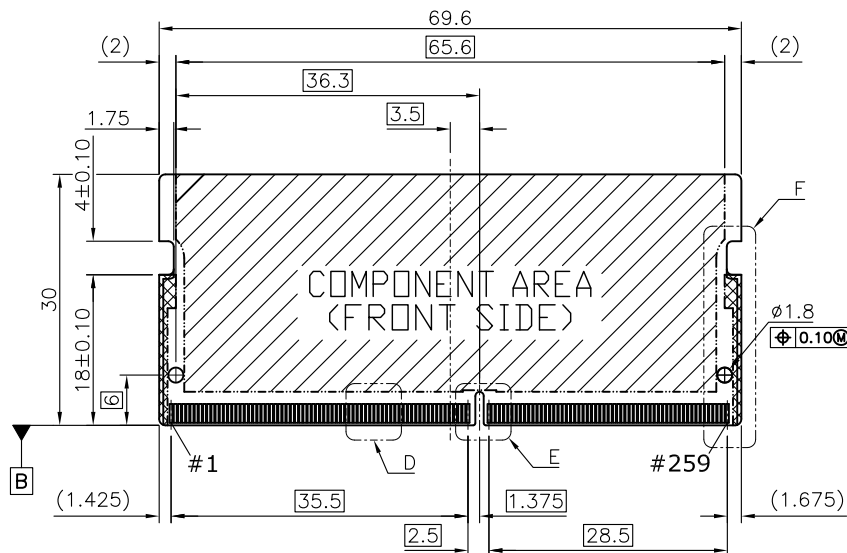

Detail F

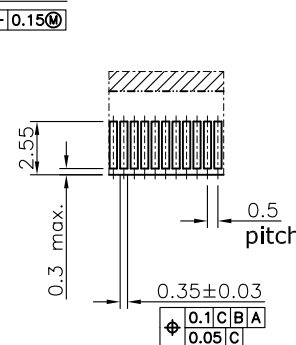
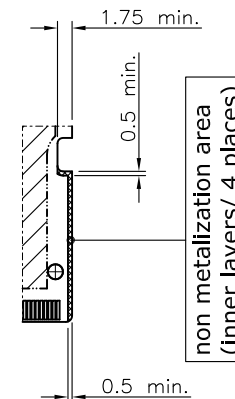

Detail D  
SCALE 3.125

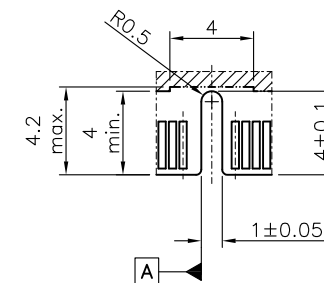

Detail E  
SCALE 3.125

Note: tolerance on dimensions is  $\pm 0.15$  unless otherwise specified.

RoHS Compliant

TOLERANCES ARE

**MORETHANALL**  
PCB CONNECTORS  
Cable ASSEMBLIES

DRAWING BY CY

X,  $\pm$

CHECKED BY GENIUS

.X,  $\pm$

UNIT / mm

SCALE 1 : 1

.XX,  $\pm$

DATE

.XXX,  $\pm$

ANG,  $\pm$

SIZE A4

PPOJECTION

照片框

ORDER INFORMATION

SDM5-W92V12-144116-LF

SERIES

LEADFREE

12V  
HIGH 9.2mm  
90°SMT

144+116 WAY

煜倫股份有限公司

www.morethanall.com

DESCRIPTION: DDR4 SODIMM Socket, Horizontal 9.2H, STD, G/F, Black, Reel, Solder PEG