

Recommended P.C.B Layout

MATERIAL

Contact Pin : Brass
Insulation Material: LCP

SPECIFICATION

Current Rate : 3 AMP
Insulation Resistance : 5000MΩMin. at DC 500V
Contact Resistance : 20mΩMax. at DC 100mA
Dielectric Voltage : AC 500V for one minute

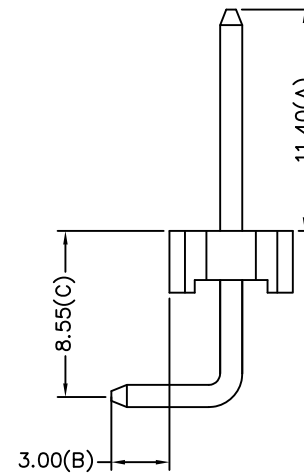

RoHS Compliant

TOLERANCES ARE

MORETHANALL
PCB CONNECTORS
Cable ASSEMBLIES

DRAWING BY CY

CHECKED BY GENIUS

UNIT / mm

SCALE 1 : 1

DATE

SIZE A4

X ±
.X ± 0.30
.XX ± 0.20
.XXX ±
ANG ±

PPOJECTION

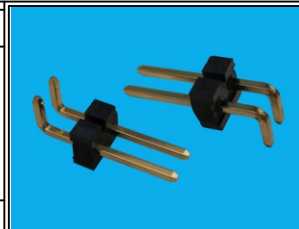

ORDER INFORMATION

H39-RL3153114030-1Xxx-LF
SERIES | | | | | LEADFREE
1X02:02 WAY
1X30:30 WAY
DIP 90°
LOW CONTACT 11.40mm
BASE 3.18mm R/A 5.37mm

煜倫股份有限公司

www.morethanall.com

DESCRIPTION: