

# SPECIFICATIONS

Voltage rating:300V AC,DC

Current rating:12A AC,DC

Withstanding voltage:1500V AC/minute

Insulation resistance:1000M OHM min

Temperature range:-25°C~+90°C

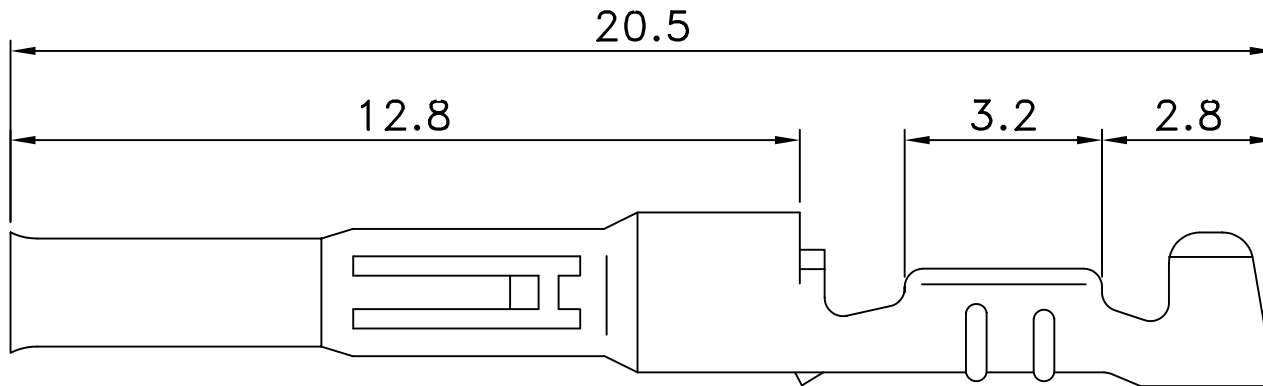

Part NO	WIRE RANGE	O.D.OF WIRE INSULATION	MATERIAL	PLATING	QUANTITY PER REEL
	AWG				
L-F-14	20-14	1.9-3.4	PHOSPHOR BRONZE	TIN-PLATED	3500
L-F-20	24-20	1.5-2.7	PHOSPHOR BRONZE	TIN-PLATED	5000

RoHS Compliant

TOLERANCES ARE

**MORETHANALL**  
PCB CONNECTORS  
Cable ASSEMBLIES

煜倫股份有限公司

www.morethanall.com

DRAWING BY CY

CHECKED BY GENIUS

UNIT / mm

SCALE 1 : 1

DATE

SIZE A4

PJECTION

X. ±  
.X ±  
.XX ±  
.XXX ±  
ANG ±

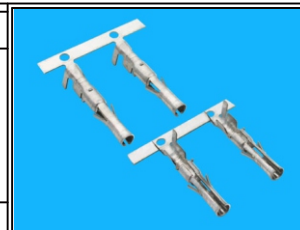

### ORDER INFORMATION

L-F-xx-LF  
SERIES | LEADFREE  
14:14~20WAY  
20:20~24WAY  
FEMALE TERMINAL

DESCRIPTION: