

Notes:

1. Material:  
Housing: Thermoplastic UL 94V-0, Black  
Terminal: Copper Alloy
2. Finish:  
Terminal: Selected Gold on Contact Area,  
Gold Flash on Solder Tails, Both over  
50u" Min. Nickel Under-plated Overall

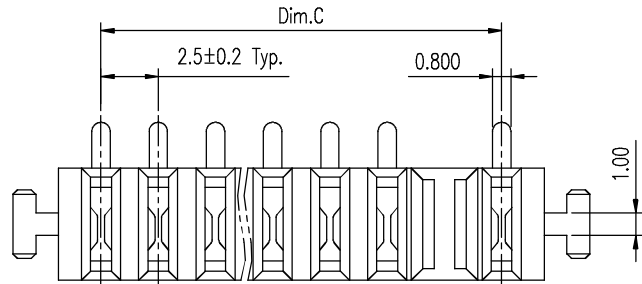

Dimension Information:

Part No.	Dim.	Amount of Pins	Dim.A	Dim.B	Dim.C	Dim.D
BCC25-SV65R2P-05		5	20.20	16.20	12.50	11.65
BCC25-SV65R2P-07		7	25.20	21.20	17.50	16.65
BCC25-SV65R2P-10		10	32.70	28.70	25.00	24.15

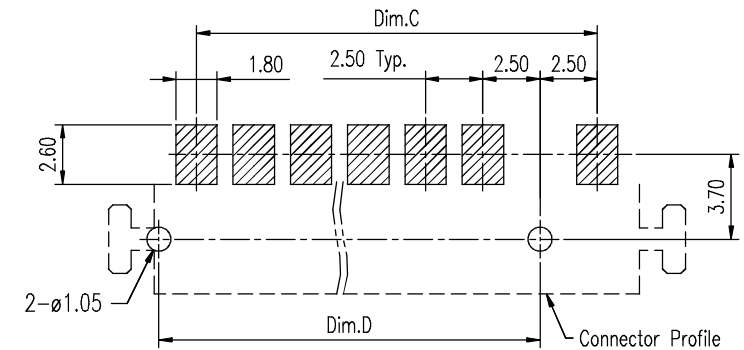
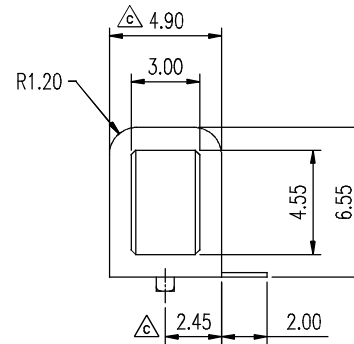
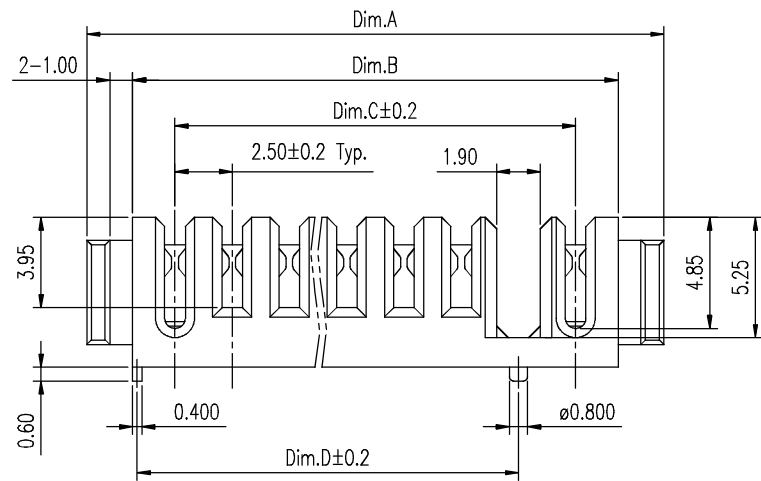

Recommended P.C.B. Layout  
Layout Tolerance = ± 0.05mm

RoHS Compliant

TOLERANCES ARE

**MORETHANALL**  
PCB CONNECTORS  
Cable ASSEMBLIES

DRAWING BY CY

X ±

CHECKED BY GENIUS

.X ± 0.38

UNIT / mm

SCALE 1 : 1

.XX ± 0.25

DATE

.XXX ± 0.13

ANG ±

SIZE A4

PJECTION

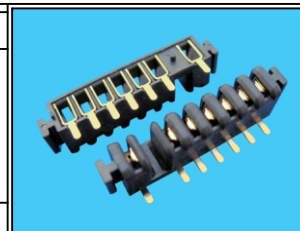

ORDER INFORMATION

BCC25-SV65R2P-xx-LF

SERIES

|

|

|

|

|

|

|

|

|

LEADFREE

FEMALE

POST

RIGHT KEY #2

HIGH 6.55mm

180°SMT

05~10WAY

POST

RIGHT KEY #2

HIGH 6.55mm

180°SMT

煜倫股份有限公司

www.morethanall.com

DESCRIPTION: 2.5mm Pitch Battery Conn. Female Type