

Material: Brass or phosphor bronze  
 Current rating: 1A, AC/DC  
 Voltage rating: 125V, AC/DC  
 Applicable wire range: AWG#24-28

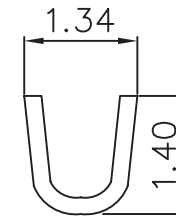

B-B

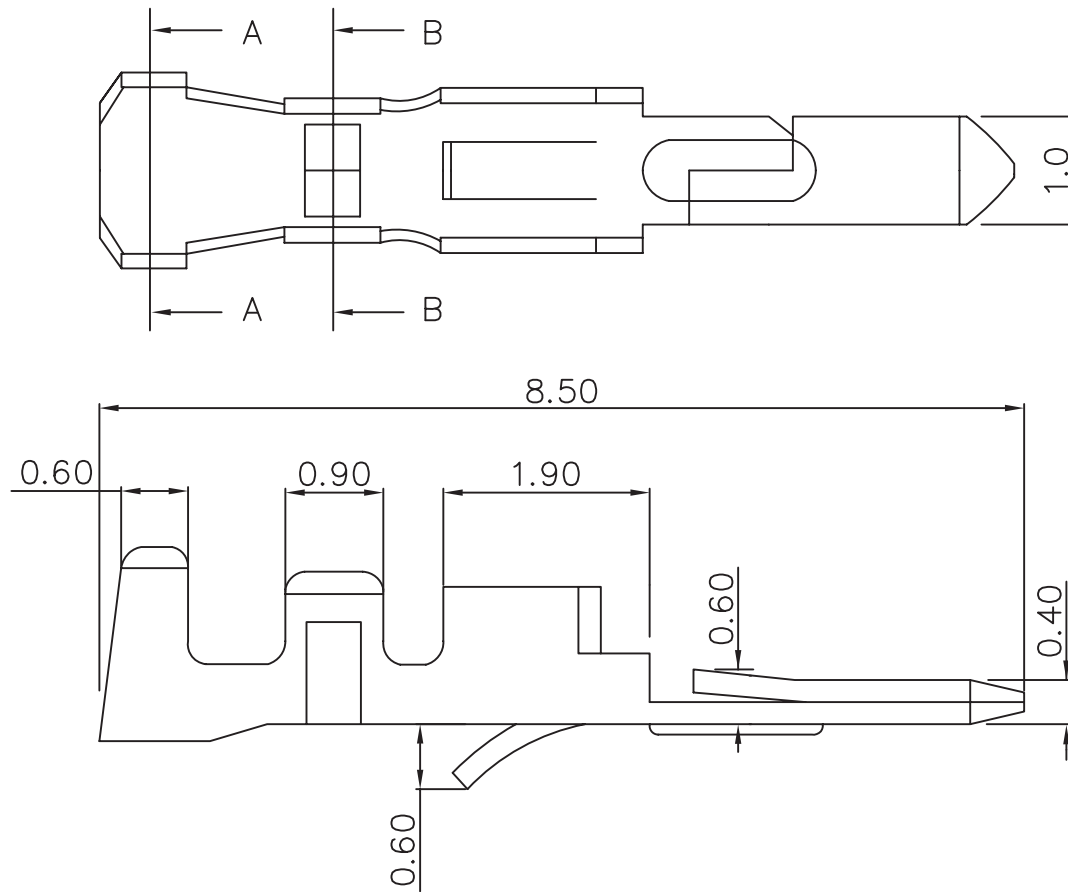
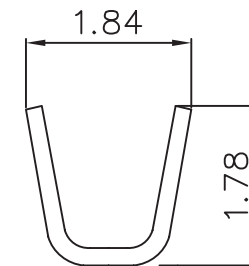

A-A



RoHS Compliant

TOLERANCES ARE

**MORETHANALL**  
 PCB CONNECTORS  
 Cable ASSEMBLIES

煜倫股份有限公司

www.morethanall.com

DRAWING BY CY

CHECKED BY GENIUS

UNIT/mm SCALE 1:1

DATE

SIZE A4

X. ±  
 .X ±  
 .XX ±  
 .XXX ±  
 ANG ±

P PROJECTION

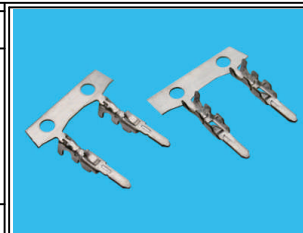

ORDER INFORMATION

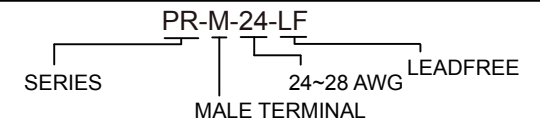

DESCRIPTION: