

NOTES :

1. MATERIAL IS COPPER ALLOY (T=0.12mm)
2. PLATING :
 - 2.1: 50u" MIN NICKEL UNDER PLATING OVER ALL
1: GOLD FLASH 1u" MIN. ON PLATED AREA
A: 3u"MIN GOLD ON PLATED AREA
 - 2.2: 100u" MIN NICKEL UNDER PLATING OVER ALL
T: 10u"MIN GOLD ON PLATED AREA
3. WIRE RANGE: SUITABLE FOR
UL3302 AWG#28 OD=0.6mm
UL3302 AWG#30 OD=0.7mm
UL3302 AWG#32 OD=0.55mm
CURRENT RATING: 1AMPERES (PER PIN)
4. CRIMPING TOOLING REF.:
 - A. CONDUCTOR CRIMPIN: W=0.85mm(REF.)
 - B. INSULATOR CRIMPING: W=0.90mm(REF.)
5. AFTER CRIMPING, CONTROL TERMINAL LENGTH: 1.0mm MAX.

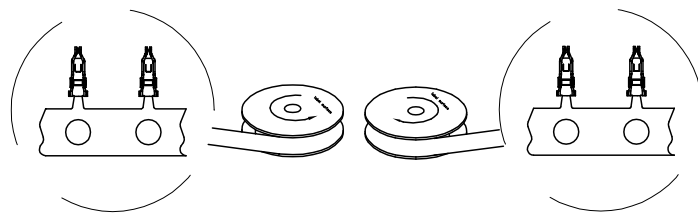
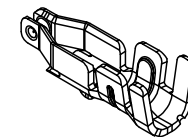
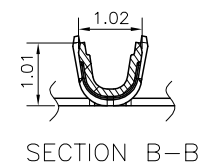
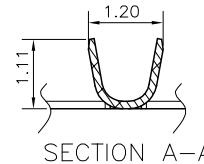

WIND OPERATION AFTER STAMPING AND BEFORE PLATING

WIND OPERATION AFTER PLATING AND BEFORE ASSEMBLY

RoHS Compliant

TOLERANCES ARE

MORETHANALL
PCB CONNECTORS
Cable ASSEMBLIES

DRAWING BY CY

X. ± 0.50

CHECKED BY GENIUS

.X ± 0.25

UNIT / mm

SCALE 1 : 1

.XX ± 0.15

DATE

.XXX ± 0.10

ANG ± 2°

SIZE A4

PJECTION

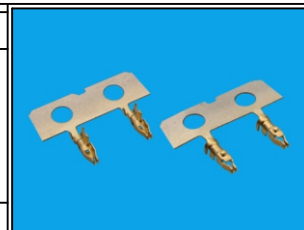

ORDER INFORMATION

ACH-TG-28-HF
SERIES | T HALOGEN FREE
28-32AWG
GOLD
TERMINAL

煜倫股份有限公司

www.morethanall.com

DESCRIPTION: ERMINAL FOR 1.2mm WTB CONN.