

● **MATERIALS: (RoHS Compliant)**

Housing And Cover: PBT+Glass Fiber UL94V-0, Black

Contacts: Phosphor Bronze Gold Selective Plated

Back Shell: Zinc Alloy,Nickel Plated Over Copper

Shell: Steel,Nickel Plated Over Copper

Jackscrew: Steel,Nickel Plated Over Copper

Cable Clipper: Steel,Nickel Plated Over Copper

Flat Screws: Steel,Nickel Plated Over Copper

● **ELECTRICAL CHARACTERISTICS:**

Contact Current Rating: 0.5 Amp

Dielectric Withstanding Voltage: 250V AC

Insulation Resistance: >500MΩ/Min

Contact Resistance: 35mΩ/Max

Operation Temperature: -55°C ~ +85°C

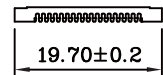
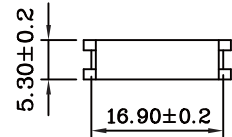
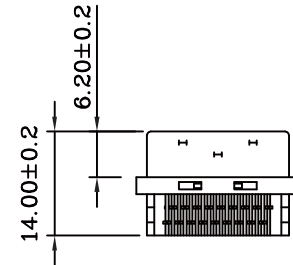
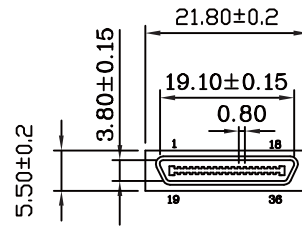

Termination Cover  
(2 Places)

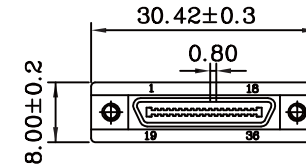
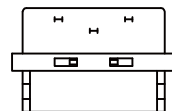
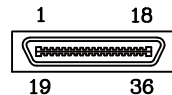

M2.6 Flat Screw (2 Places)  
M2.0 Jack Screw (2 Places)

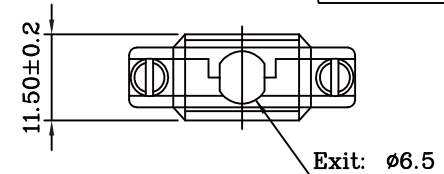
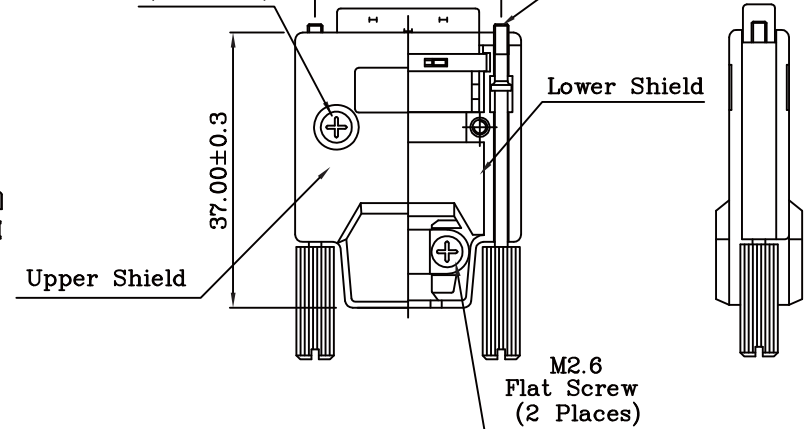

Cable Clipper



煜倫股份有限公司

www.morethanall.com

RoHS Compliant

DRAWING BY CY

CHECKED BY GENIUS

UNIT / mm SCALE 1:1

DATE

SIZE A4

TOLERANCES ARE

X. ±

.X ±

.XX ±

.XXX ±

ANG ±

PJECTION

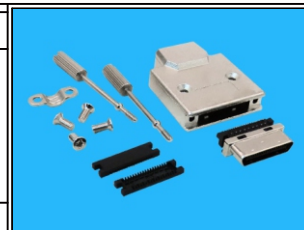

ORDER INFORMATION

VHC-PF2M-036-LF  
SERIES | LEADFREE  
36 WAY  
METAL  
IDC  
MALE

DESCRIPTION: 0.8(.0315") (VHDCI) 36P Cable Plug Connector I.D.C Assembly Type