

● MATERIALS: (RoHS Compliant)

Housing And Cover: PBT+Glass Fiber UL94V-0, Black
 Contacts: Phosphor Bronze Gold Selective Plated
 Shell: Steel,Nickel Plated Over Copper

● ELECTRICAL CHARACTERISTICS:

Contact Current Rating: 0.5 Amp
 Dielectric Withstanding Voltage: 250V AC
 Insulation Resistance: >500MΩ/Min
 Contact Resistance: 35mΩ/Max
 Operation Temperature: -55°C ~ +85°C

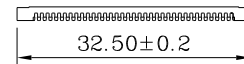
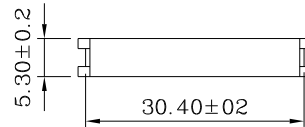
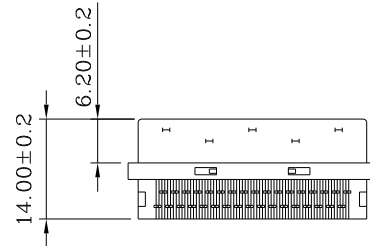
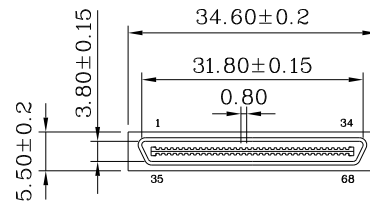

Termination Cover
(2 Places)

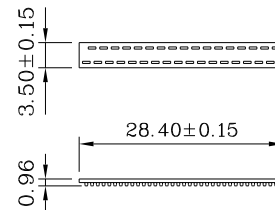

Wire Holder
(2 Places)

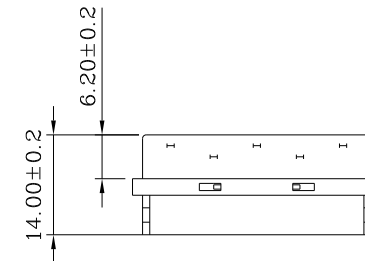
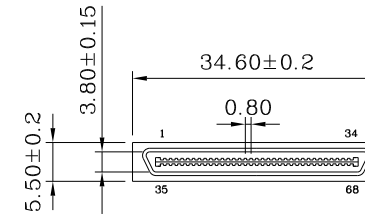

RoHS Compliant

TOLERANCES ARE

MORETHANALL
 PCB CONNECTORS
 Cable ASSEMBLIES

煜倫股份有限公司

www.morethanall.com

DRAWING BY CY

CHECKED BY GENIUS

UNIT / mm SCALE 1 : 1

DATE

SIZE A4

X. ±
 .X ±
 .XX ±
 .XXX ±
 ANG ±

PPOJECTION

照片框

ORDER INFORMATION

VHC-PF2-068-LF
 SERIES | LEADFREE
 | 68 WAY
 | IDC
 | MALE

DESCRIPTION: 0.8(.0315") (VHDCI) 68P Cable Plug Connector I.D.C Molded Type