

NOTES :

1. MATERIAL:

- A. HOUSING : LCP E130i, HIGH TEMP,UL94V-0 .
- B. CONTACT : CU01.
- C. MID-PLATE : SUS301.
- D. SHELL : SUS304.
- E. OUTER SHELL : SUS304.

2. FINISH:

- CONTACT : Au ON CONTACT AREA(SEE NOTES 3)
- 100u"(Min) MATTE TIN ON SOLDER AREA
- 80u"(Min) NICKEL UNDERPLATING OVERALL .

3. ELECTRICAL CHARACTERISTIC:

- 3-1. CURRENT RATING: 3A
- VOTAGE RATING: 5V
- 3-2. LOW LEVEL CONTACT RESISTANCE:
- 40mohms MAX. FOR VBUS, GND AND OTHER CONTACTS.
- 50mohms MAX. AFTER ENVIRONMENT TEST.

4. MECHANICAL CHARACTERISTIC:

- 4-1. INSERTION FORCE: 5~20N.
- 4-2. EXTRACTION FORCE: 8~20N.
- 4-3. DURABILITY: 10000 MATING CYCLES
- 4-4. OPERATING TEMPERATURE: -55°C TO +85°C.

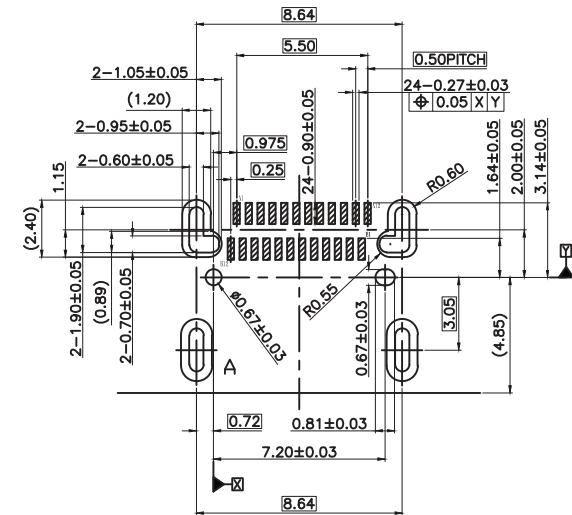

RECOMMENDED PCB LAYOUT (TOP VIEW)

PCB THICKNESS 0.80±0.05mm

PIN ASSIGNMENT											
A1	A2	A3	A4	A5	A6	A7	A8	A9	A10	A11	A12
GND	TX1-	TX1-	VBUS	CC1	D+	D-	RFU1	VBUS	RX2-	RX2+	GND
GND	RX1+	RX1-	VBUS	RFU2	D-	D+	CC2	VBUS	TX2-	TX2	GND
B12	B11	B10	B9	B8	B7	B6	B5	B4	B3	B2	B1

RoHS Compliant

TOLERANCES ARE

**MORETHANALL**  
PCB CONNECTORS  
Cable ASSEMBLIES

DRAWING BY CY

X, ±

CHECKED BY GENIUS

.X ± 0.25

UNIT / mm

SCALE 1 : 1

.XX ± 0.15

DATE

.XXX ± 0.10

ANG ±

SIZE A4

PJECTION

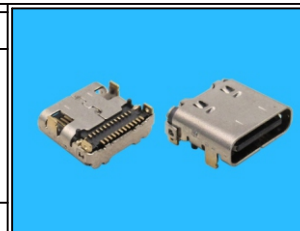

ORDER INFORMATION

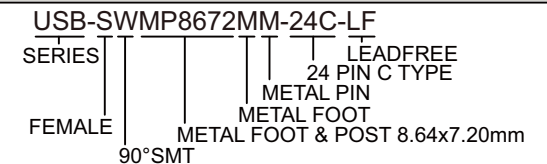

煜倫股份有限公司

www.morethanall.com

DESCRIPTION: USB TYPE C R/A DUAL-ROW SMT TYPE CH=1.58mm H=3.41mm