

ELECTRICAL :

1. VOLTAGE RATING : 125V.
2. CURRENT RATING : 1.5A.
3. CONTACT RESISTANCE : 30 MILLIOHMS MAX.
4. INSULATION RESISTANCE : 500 MEGOHM MIN.
5. DIELECTRIC WITHSTANDING VOLTAGE : 1000VAC, RMS, 60Hz, 1MINUTE.

MECHANICAL :

1. PLUG RETAINED FORCE : 11KG MAX.
2. DURABILITY : 750 MATING CYCLES MIN.
3. OPERATING TEMPERATURE : -40°C ~ +125°C.

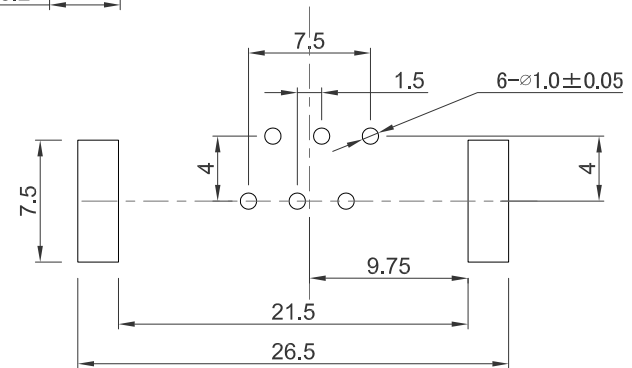
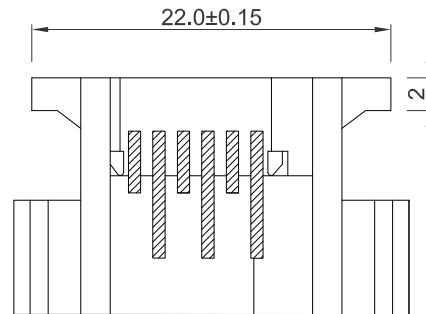
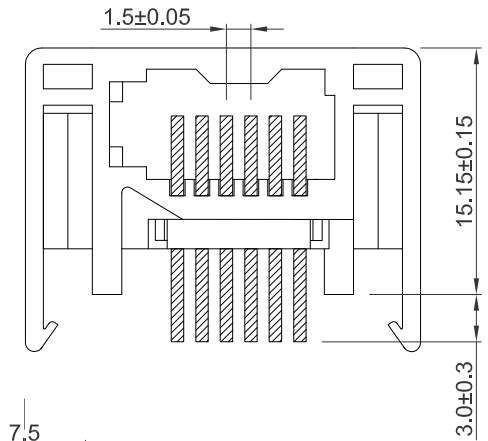
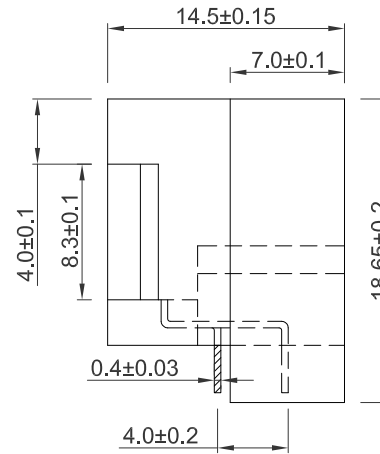
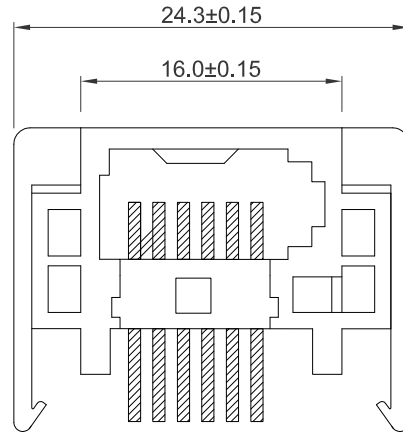

PCB LAYOUT

TECHNICAL DATA			
HOUSING	STANDARD MATERIAL	15% GLASS FILLED PBT <input checked="" type="checkbox"/> UL94V-0 <input type="checkbox"/> UL94V-2	COLOR <input type="checkbox"/> BLACK <input checked="" type="checkbox"/> WHITE
		<input type="checkbox"/> W/FLANGE <input type="checkbox"/> W/O FLANGE	
CONTACT		<input checked="" type="checkbox"/> ROUND WIRE : 0.40mm DIAMETER PHOSPHOR BRONZE GOLD PLATED OVER NICAL.	
		<input type="checkbox"/> FLAT WIRE : 0.35mm THICKNESS PHOSPHOR BRONZE GOLD PLATED OVER NICAL.	
		TIN PLATED OVER NICKEL ON SOLDER AREA.	
GOLD-PLATING		<input type="checkbox"/> 0.0762um/3u inch <input checked="" type="checkbox"/> 0.15um/6u inch <input type="checkbox"/> 0.38um/15u inch <input type="checkbox"/> 0.76um/30u inch <input type="checkbox"/> 1.27um/50u inch	
TYPE OF JACK		<input checked="" type="checkbox"/> UNSHIELD <input type="checkbox"/> SHIELD : 0.25mm THICKNESS COPPER ALLOY WITH NICKLE PLATED.	

UK-JRL-0606RV-LF
LEADFREE
RoHS Compliant

	PART NO. UK-JRL-0606RV		TOLERANCES ARE X, ± .XX ± 0.38 .XXX ± 0.25 .XXX ± 0.10 ANG	DESCRIPTION:			
	DWG NO. UK-JRL-0606RV						CHECKED BY CY
焯倫股份有限公司	FILE NO.		DRAWING BY		AREA	REVISIONS	DATE
	UNIT / mm	SCALE 1:1	PROJECTION				