

**Material:**

Housing: 30% Glass Filled PBT UL94V-0.

Contacts: Phosphor Bronze.

Lock: Phosphor Bronze.

**Electrical Characteristics:**

Current Rating: 2 AMP.

Dielectric Withstanding Voltage: AC 1000V For 1 minute.

Insulator Resistance: 1000MΩ min. at DC 500V.

Contact Resistance: 30mΩ max. at DC 100mA.

Operating Temperature: -55°C~+105°C .

**\*RoHS Compliant**

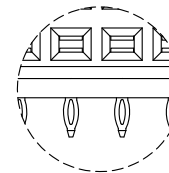
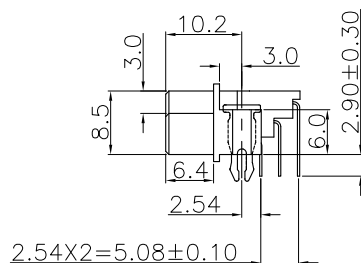
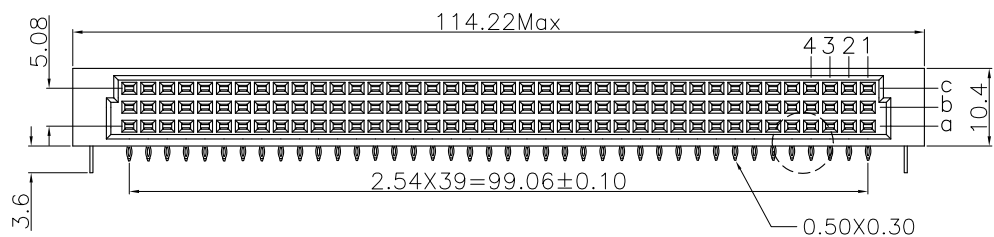

Press Fit Type

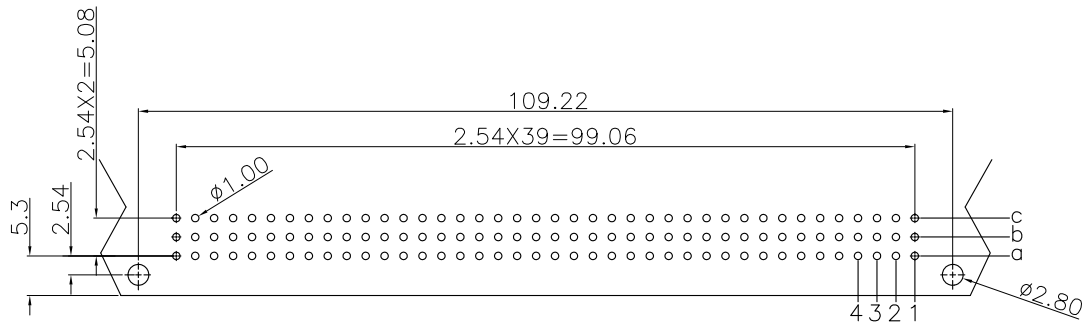

P.C. Board Layout  
(Tolerance:±0.05)

UC-SQZ-3X40-LF  
LEADFREE  
RoHS Compliant

	PART NO. UC-SQZ-3X40		CHECKED BY CY	TOLERANCES ARE .X ± 0.2 .XX ± .XXX ± AWG	DESCRIP TION:	AREA	REVISIONS	HK	DATE
	DWG NO. UC-SQZ-3X40								
	FILE NO.		PROJECTION						
	UNIT / mm	SCALE 1:1							