

RECOMMENDED P.C.B LAYOUT(TOP VIEW)
TOLERANCES: $\pm 0.10\text{mm}$

SPECIFICATION

MATERIAL

Insulator: PBT, rated UL94V-0 (standard)
Contacts: Brass (Male) ; Phosphor Bronze (Female)
Rivet, Boardlock: Copper alloy

CONTACT PLATING

Underplate: 40m Nickel
Contact area: 1m²~30m² Selective gold
Solder tails area: 100m² Tin/Lead

ELECTRICAL

Operation voltage: 250 VAC max.
Current rating: 3 Amps max.
Contact resistance: 20 mohms max.
Insulation resistance: 3000 Mohms min @ 500 VDC
Dielectric withstanding voltage: 1000 VAC / minute

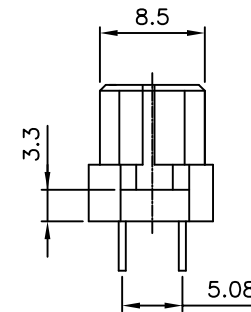

RoHS Compliant

TOLERANCES ARE

MORETHANALL
PCB CONNECTORS
Cable ASSEMBLIES

DRAWING BY CY

CHECKED BY GENIUS

UNIT / mm

SCALE 1 : 1

DATE

SIZE A4

X, \pm
.X \pm 0.30
.XX \pm 0.20
.XXX \pm
ANG \pm

PJECTION

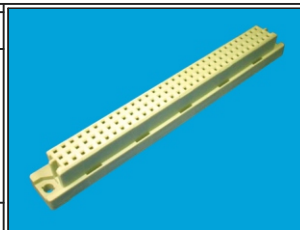

ORDER INFORMATION

UC-SD-2X32-LF
SERIES | LEADFREE
64 WAY
DIP 180°
FEMALE

煜倫股份有限公司

www.morethanall.com

DESCRIPTION: DIN 41612 (THREE ROW) FEMALE 64PIN