

Notes: (Unless Otherwise Specified)

1. Waterproof Rate: IP67.
2. Recommend Panel Thickness: 0.8 to 3.0 mm.
3. Recommend Torque: 9~10 Kgf-cm.
4. RoHS Compliant.
5. Type C AB面接點需跟圖面一致.
6. UL Certification file #E364108.

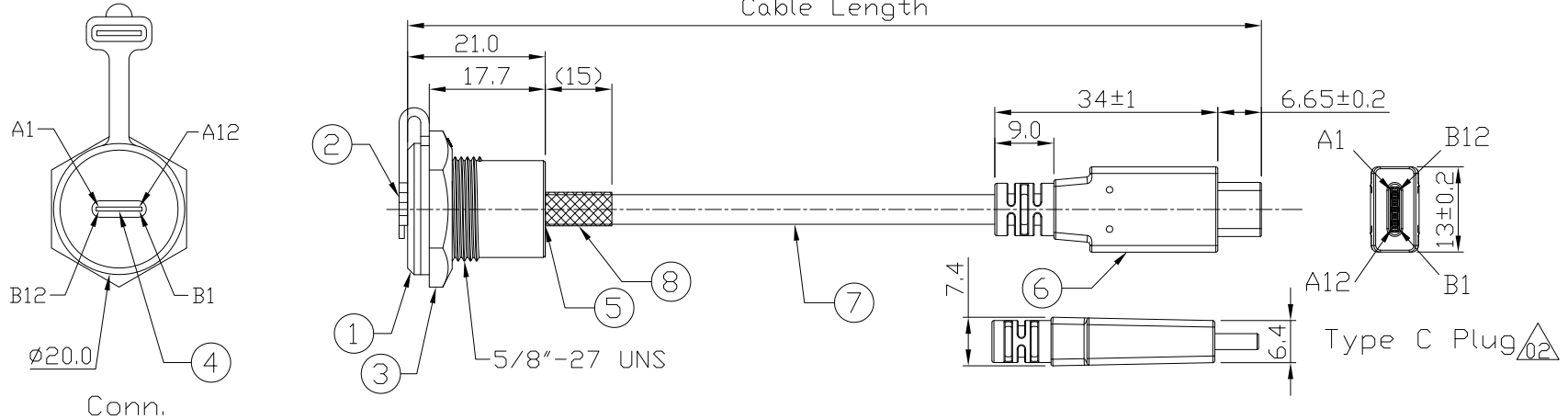

8	Shrink Tube	L=20mm, Heat Shrink Tube With Adhesive Lined Color: Black	1
7	Cable	UL21572 (1P/32#+EAM)*4+(1P/32#+A)+(4C/32#+)+(1C/24#+)+2EAB 85% OD:4.8mm Black TPE Jacket.	1
6	Over Mold	PVC Color: Black	1
5	Glue	Epoxy Color: Black	
4	USB Type C 3.1	Housing: Thermoplastic, Color: Black Contacts: Copper Alloy, Finish: Au Plated Shell: Stainless Steel, Finish: Au Plated	2
3	Hex Nut	Thermoplastic Color: Black	1
2	Cap	Silicone Color: Black	1
1	Housing	Thermoplastic Color: Black	1
Item	Part Name	Material / Finish	Q'ty

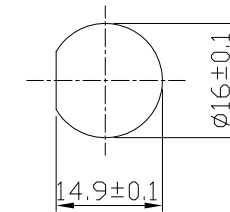

Recommend  
Panel Cut-Out

2000 mm	+100
1000 mm	+50
900 mm	+50
800 mm	+50
700 mm	+50
600 mm	+50
500 mm	+50
400 mm	+50
300 mm	+25
200 mm	+25
100 mm	+25
Cable Length	Tol.

RoHS Compliant

TOLERANCES ARE

**MORETHANALL**  
PCB CONNECTORS  
Cable ASSEMBLIES

煜倫股份有限公司

www.morethanall.com

DRAWING BY CY

CHECKED BY GENIUS

UNIT / mm  
SCALE 1 : 1  
DATE

SIZE A4

X, ±  
.X ± 0.50  
.XX ± 0.20  
.XXX ± 0.05  
ANG ± 1°

PJECTION

照片框

ORDER INFORMATION

UBWPUB-24C24C2432DC16-Exxx-LF

SERIES

24 TO 24 WAY C TYPE

24/32 AWG

160  
DUST COVER

LEADFREE  
10C:100mm  
2M:2000mm  
MALE TO FEMALE

DESCRIPTION:USB 3.1 Type C Plastic C2 Panel Jack With Type C Plug+Cap

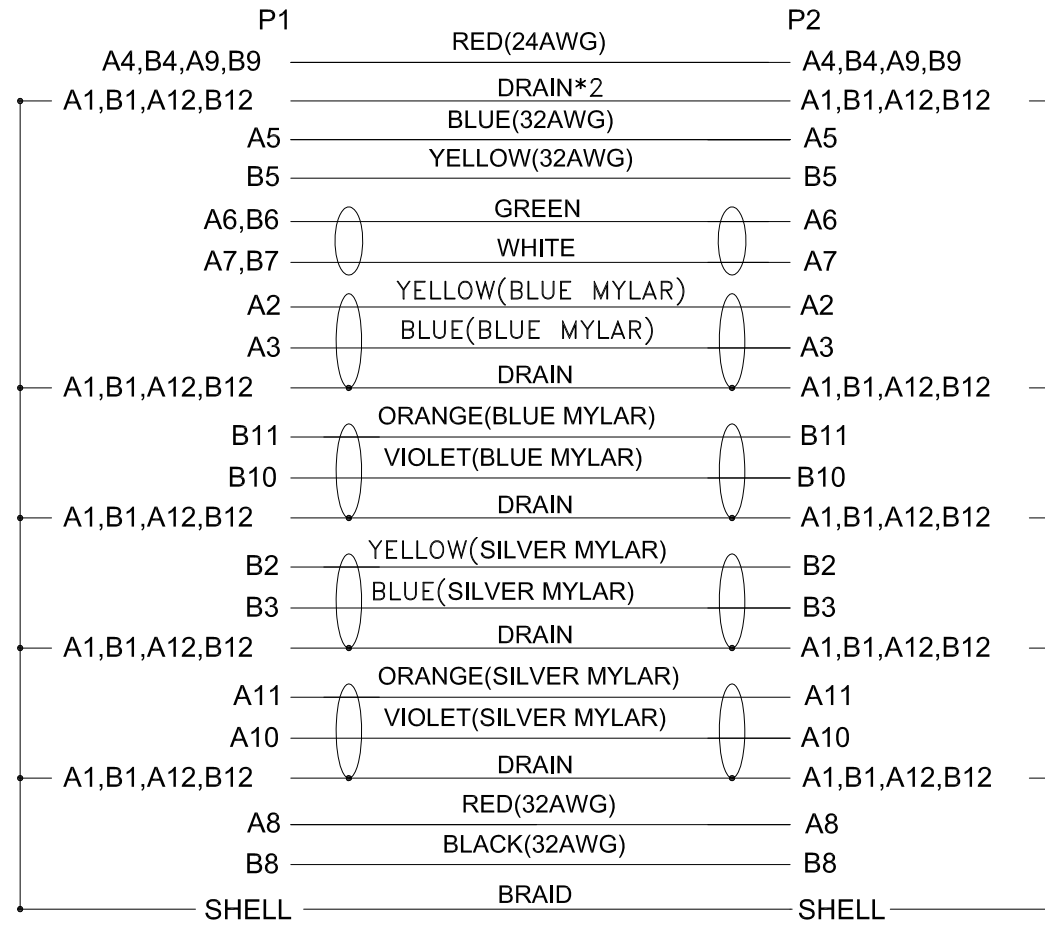

Conn.

Type C Plug

Wiring Diagram

RoHS Compliant

TOLERANCES ARE



DRAWING BY CY

CHECKED BY GENIUS

UNIT / mm

SCALE 1 : 1

DATE

X, ±  
 .X ± 0.50  
 .XX ± 0.20  
 .XXX ± 0.05  
 ANG ± 1°

煜倫股份有限公司

www.morethanall.com

SIZE A4

PPOJECTION



ORDER INFORMATION

UBWPUB-24C24C2432DC16-Exxx-LF

SERIES

24 TO 24 WAY C TYPE

24/32 AWG

16Ø  
 DUST COVER

LEADFREE  
 10C:100mm  
 2M:2000mm  
 MALE TO FEMALE

DESCRIPTION:USB 3.1 Type C Plastic C2 Panel Jack With Type C Plug+Cap