

**Material:**

Housing: 30% Glass Filled PBT UL94V-0.  
 Contacts: Phosphor Bronze

**Electrical Characteristics:**

Current Rating: 2 AMP.  
 Dielectric Withstanding Voltage: AC1000V For 1 minute.  
 Insulator Resistance: 1000MΩ min. at DC 500V.  
 Contact Resistance: 30mΩ max. at DC 100mA.  
 Operating Temperature: -55°C ~+105°C.

**\*RoHS Compliant**

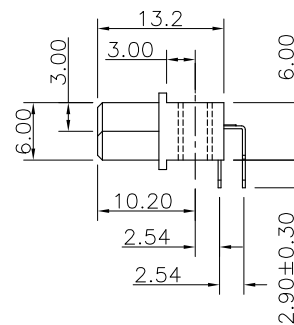
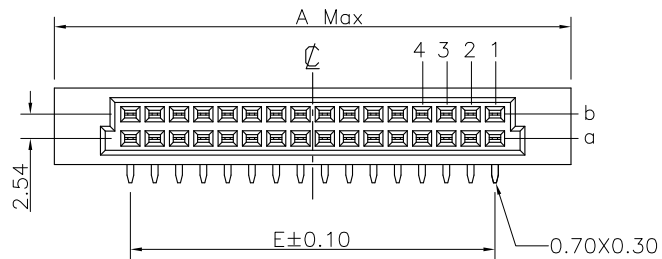

P/N	A	B	C	D	E
UB-SR-2X16	54.0	48.26	42.36	44.36	38.1
UB-SR-2X10	38.76	33.0	27.12	29.12	22.86

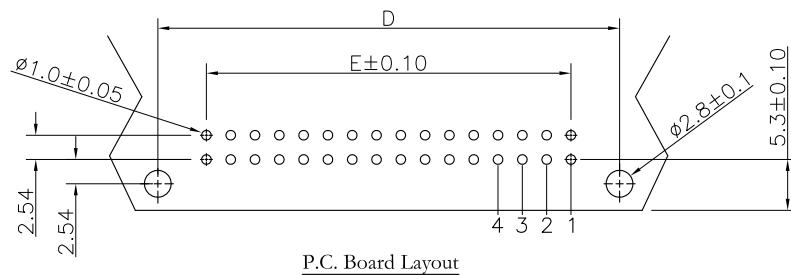

P.C. Board Layout

P/N	Contact Arrange	Rows With Contacts	Position	Pitch
UB-SR-2X16		a b	32	2.54mm
UB-SR-1X16		a -	16	
UB-SR-2X10		a b	20	
UB-SR-1X10		a -	10	
UB-SR-2X16E0		a b	16	5.08mm
UB-SR-1X16E0		a -	8	
UB-SR-2X10E0		a b	10	
UB-SR-1X10E0		a -	5	

UB-SR-2Xxx-LF  
 LEADFREE

RoHS Compliant

**MORETHANALL**  
 CONNECTORS  
 ASSEMBLIES

煜倫股份有限公司

PART NO. UB-SR-2Xxx		CHECKED BY CY		TOLERANCES ARE .X ± 0.2 .XX ± .XXX ± AWG	DESCRIP TION:
DWG NO. UB-SR-2Xxx		DRAWING BY			
FILE NO.		PROJECTION		AREA	REVISIONS
UNIT / mm	SCALE 1:1			HK	DATE