

Material:

Housing: 30% Glass Filled PBT UL94V-0.

Contacts: Phosphor Bronze.

Lock: Phosphor Bronze.

Electrical Characteristics:

Current Rating: 2 AMP.

Dielectric Withstanding Voltage: AC 1000V For 1 minute.

Insulator Resistance: 1000MΩ min. at DC 500V.

Contact Resistance: 30mΩ max. at DC 100mA.

Operating Temperature: -55°C ~ +105°C .

***RoHS Compliant**

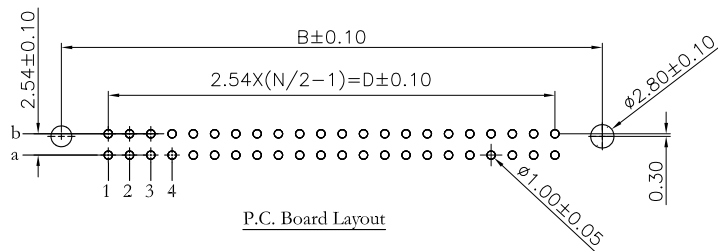
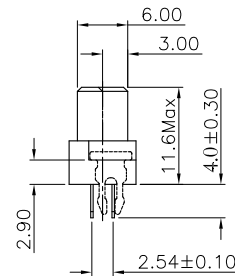
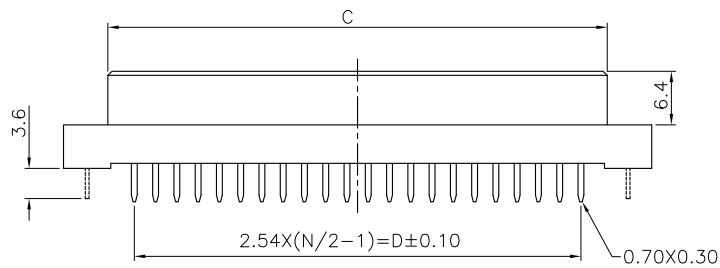

UB-SDZ-2Xxx-LF
LEADFREE
RoHS Compliant

Dimension		A	B	C	D
Position					
44/22/11		70.24	64.60	59.64	53.34
32/16/8		55.0	49.36	44.36	38.10
2.54mm	44	a b		UB-SDZ-2X22	
	32	a b		UB-SDZ-2X16	
	22	a -		UB-SDZ-1X22	
	16	a -		UB-SDZ-1X16	
5.08mm	22	a b		UB-SDZ-2X22E0	
	16	a b		UB-SDZ-2X16E0	
	11	a -		UB-SDZ-1X22E0	
	8	a -		UB-SDZ-1X16E0	
Pitch	Position	Rows With Contacts	Contact Arrange	P/N	

MORETHANALL
CONNECTORS
ASSEMBLIES

PART NO. UB-SDZ-2Xxx

DWG NO. UB-SDZ-2Xxx

FILE NO.

煜倫股份有限公司

UNIT / mm

SCALE 1:1

CHECKED BY CY

DRAWING BY

PROJECTION

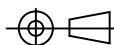

TOLERANCES ARE

.X ± 0.2

.XX ±

.XXX ±

AWG

DESCRIPTION:

AREA

REVISIONS

HK

DATE