

RTSW10-D065-16RA

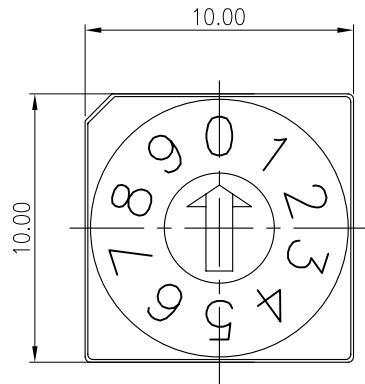

RTSW10-D065-10RA

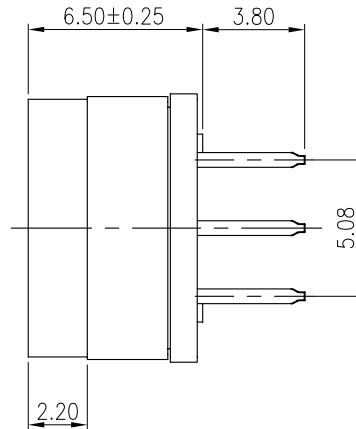

NOTE:

1.GENERAL TOLERANCES MAX.±0.20mm.

SPECIFICATIONS

- 1.RATING : NON SWITCHING RATING 24VDC 400mA  
SWITCHING RATING 24VDC 150mA
- 2.LIFF : 10,000 STEPS
- 3.OPERATING FORCE : 400gf·cm Max.
- 4.INITIAL CONTACT RESISTANCE : 100mOhm Max.
- 5.DIELECTRIC STRENGTH : AC 250V 1 MINUTE
- 6.INSULATION RESISTANCE : 100MOhm Min.  
(DC 250V MEGGER)
- 7.OPERATING TEMPERATURE : -60°C TO 125°C

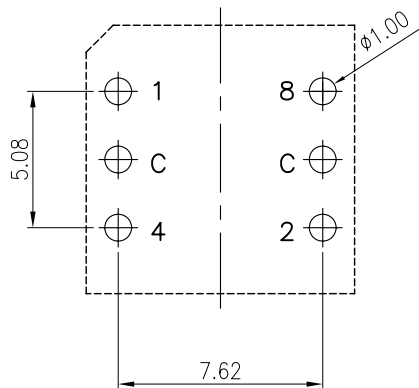

P.C.B. LAYOUT

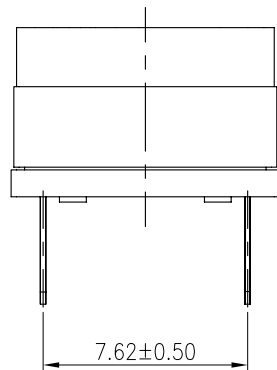

TYPE	CIRCUIT CHARACTERISTICS												
	CODE	POSITION ●ON											
RTSW10-D065-10RA	1	●	●	●	●	●	●	●	●				
	2		●	●		●	●						
	4				●	●	●						
	8								●	●			
TYPE	CIRCUIT CHARACTERISTICS												
	CODE	POSITION ●ON											
RTSW10-D065-16RA	1	●			●		●		●		●		●
	2		●	●		●	●		●	●		●	●
	4				●	●	●				●	●	●
	8								●	●	●	●	●

**RoHS Compliant**

TOLERANCES ARE



**煜倫股份有限公司**

www.morethanall.com

DRAWING BY CY		X.± .X± .XX± .XXX± ANG±
CHECKED BY GENIUS		
UNIT / mm	SCALE 1 : 1	
DATE		
SIZE A4	PJECTION	

照片框

**ORDER INFORMATION**

RTSW10-D065-xxRA-LF

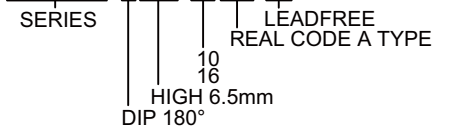

DESCRIPTION: ROTARY SWITCH