

**NOTE:**

1.GENERAL TOLERANCES MAX.±0.20mm.

**SPECIFICATIONS**

- 1.RATING : NON SWITCHING RATING 24VDC 400mA  
SWITCHING RATING 24VDC 150mA
- 2.LIFF : 10,000 STEPS
- 3.OPERATING FORCE : 400gf·cm Max.
- 4.INITIAL CONTACT RESISTANCE : 100mOhm Max.
- 5.DIELECTRIC STRENGTH : AC 250V 1 MINUTE
- 6.INSULATION RESISTANCE : 100MOhm Min.  
(DC 250V MEGGER)
- 7.OPERATING TEMPERATURE : -60°C TO 125°C

RTSW10-D065-16GA

RTSW10-D065-10GA

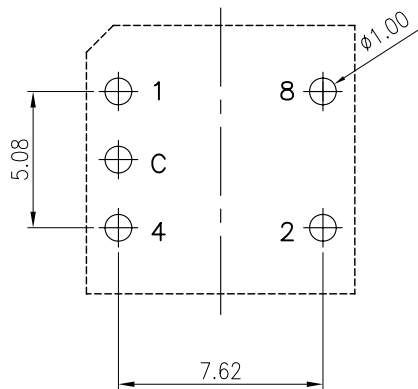

P.C.B. LAYOUT

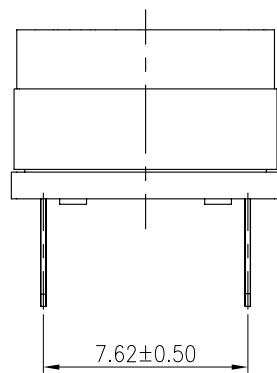

TYPE	CIRCUIT CHARACTERISTICS																	
	CODE	POSITION										●ON						
RTSW10-D065-10GA		0	1	2	3	4	5	6	7	8	9	A	B	C	D	E	F	
	1	●																
	2		●	●														
	4				●	●	●	●										
8											●	●						

TYPE	CIRCUIT CHARACTERISTICS																	
	CODE	POSITION										●ON						
RTSW10-D065-16GA		0	1	2	3	4	5	6	7	8	9	A	B	C	D	E	F	
	1		●															●
	2			●	●													
	4					●	●	●	●							●	●	●
8												●	●	●	●	●	●	

**RoHS Compliant**

TOLERANCES ARE

**MORETHANALL**  
PCB CONNECTORS  
Cable ASSEMBLIES

煜倫股份有限公司

www.morethanall.com

DRAWING BY CY

CHECKED BY GENIUS

UNIT / mm SCALE 1 : 1

DATE

SIZE A4 PROJECTION

X. ±  
.X ±  
.XX ±  
.XXX ±  
ANG ±



照片框

**ORDER INFORMATION**

RTSW10-D065-xxGA-LF

SERIES

LEADFREE  
GREY CODE A TYPE

10  
16  
HIGH 6.5mm  
DIP 180°

DESCRIPTION: ROTARY SWITCH