

L7

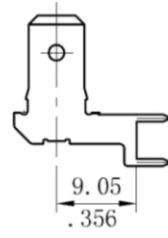

L9

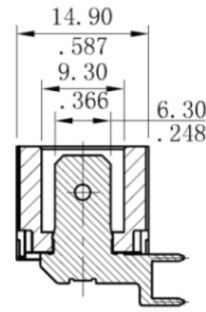
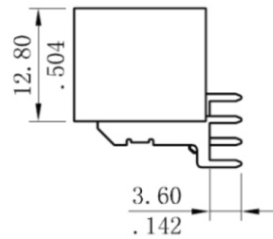
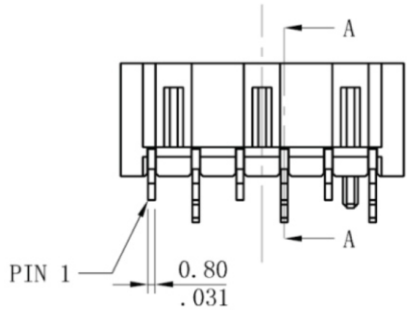

SECTION A-A

A=5.0mm (.197")*No. of circuits+2.0mm (.079")
 B=5.0mm (.197")*No. of spaces
 C=5.0mm (.197")*No. of circuits+0.2mm (.008")

Wafer:

Available in 2 through 12 circuits
 Polarized with locking ribs
 Insulator : PBT UL94V-0
 Mate with Leoco 5011 socket

Specifications

- ◆ Current rating: 16A AC,DC
- ◆ Voltage rating: 380V AC,DC
- ◆ Temperature rating: -40°C to +110°C
- ◆ Contact Resistance: 20mΩ Max.
- ◆ Insulation Resistance: 1,000MΩ Min.
- ◆ Withstanding Voltage: 1,800V AC/minute

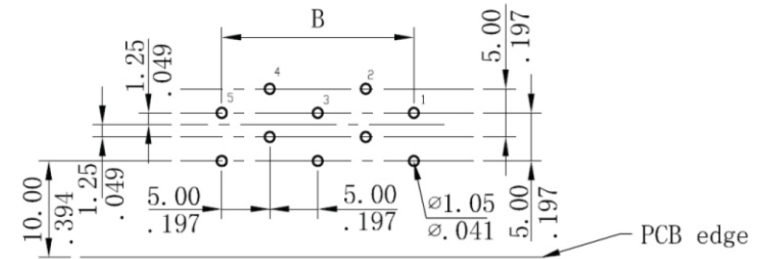

PCB layout

RoHS Compliant

TOLERANCES ARE

MORETHANALL
 PCB CONNECTORS
 Cable ASSEMBLIES

煜倫股份有限公司

www.morethanall.com

DRAWING BY CY

CHECKED BY GENIUS

UNIT / mm

SCALE 1 : 1

DATE

SIZE A4

PJECTION

X, ±
 .X ±
 .XX ±
 .XXX ±
 ANG ±

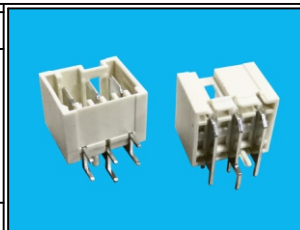

ORDER INFORMATION

RST50-PRBLy-xx0yy-LF

SERIES

MALE
 DIP 90°

7:7.85
 9:9.05
 L TYPE
 REVERSE

KEY LOCK TYPE LEADFREE

02:02WAY
 12:12WAY

DESCRIPTION: RAST 5.0 Wafer

Rast5 series keyings listed as below(view from top side)

TYPE	0A	0B	0C	0D	0E	0F	0G	0H	0I	0J	0K	0L	0M	0N	0P	0Q	0R	0S	0T	0U	0X	0Z
KEYLOCK 3way																						

05	07	09	10	11	48	80	86

TYPE	0A	0B	0C	0D	0E	0F	0G	0H	0I	0K	0L	0M	0N	0Q	0W	0I	02	03	05	08	10	11	12
KEYLOCK 3way																							

13	1A	2N	2P	31	32	38	39	40	44	53	65	80	81	98

TYPE	0A	0B	0C	0D	0E	0F	0G	0H	0I	0J	0K	0L	0M	0W	0I	02	03	04	05
KEYLOCK 4way																			

06	12	17	19	26	27	37	43	63	65	67	79	80	81	82	84	86	PA	PB

TYPE	0A	0B	0C	0D	0E	0F	0G	0L	0I	02	03	04	05	06	07	08
KEYLOCK 5way																

09	11	12	13	14	17	18	20	21	22	23	24	25	26	27	28

29	30	31	32	33	34	35	36	40	43	45	49	50	51	64	69

73	80	81	82	83	84	85	86	87	88

PB	P7

2~5 Key way

RoHS Compliant

TOLERANCES ARE

MORETHANALL
PCB CONNECTORS
Cable ASSEMBLIES

DRAWING BY CY

CHECKED BY GENIUS

UNIT / mm

SCALE 1 : 1

DATE

SIZE A4

PPOJECTION

X, ±
.X ±
.XX ±
.XXX ±
ANG ±

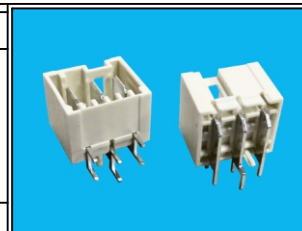

ORDER INFORMATION

RST50-PRBLY-xx0yy-LF

SERIES

KEY LOCK TYPE LEADFREE

MALE
DIP 90°

7:7.85
9:9.05
L TYPE
REVERSE

02:02WAY

12:12WAY

DESCRIPTION: RAST 5.0 Wafer

煜倫股份有限公司

www.morethanall.com

Rast5 series keyings listed as below(view from top side)

TYPE	0A	0B	0C	0D	0E	01	04	06	14	15
KEYLOCK 6-way										
	21	29	30	50	51	71	73	80	81	

TYPE	0A	0B	1B	0C	0D	0E	03	04	14	22	23	27	30
KEYLOCK 7-way													
	31	32	34	35	38	40	41	42	43	45	48	51	59
	69	76	80	81	83								

TYPE	0A	0C	0D	0E	0F	08	10	16	21	30	33	41
KEYLOCK 8-way												
	44	45	46	48	49	57	58	62	63	73	77	80
	81	83										

TYPE	0A	0B	0C	0D	08	31	42	43	48	49	52
KEYLOCK 9-way											
	53	57	58	80	81						

6~9 Key way

RoHS Compliant

TOLERANCES ARE

MORETHANALL
PCB CONNECTORS
Cable ASSEMBLIES

DRAWING BY CY

CHECKED BY GENIUS

UNIT / mm SCALE 1 : 1

DATE

SIZE A4

PPOJECTION

X, ±
.X ±
.XX ±
.XXX ±
ANG ±

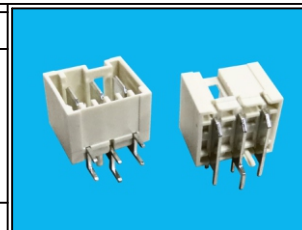

ORDER INFORMATION

RST50-PRBLY-xx0yy-LF

SERIES	KEY LOCK	TYPE	LEADFREE
MALE	7:7.85	02:02WAY	
DIP 90°	9:9.05	L TYPE	12:12WAY
	REVERSE		

煜倫股份有限公司

www.morethanall.com

DESCRIPTION: RAST 5.0 Wafer

Rast5 series keyings listed as below(view from top side)

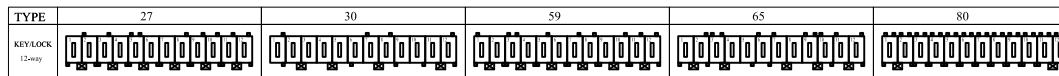
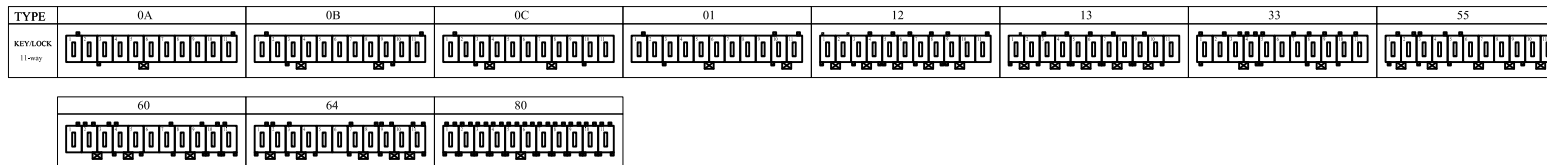
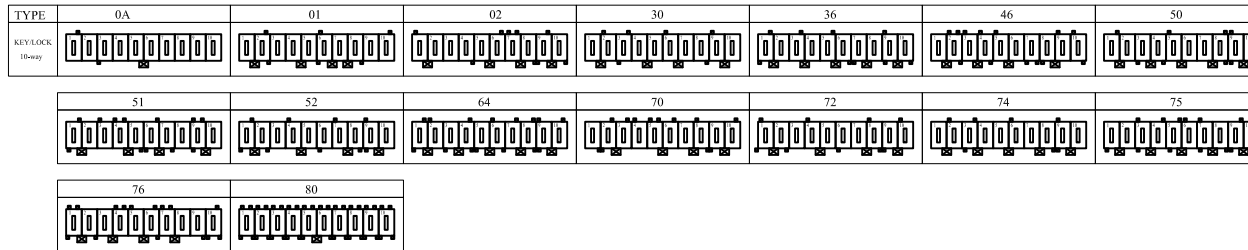

10~12 Key way

Keying drawings of Base as below(view from top side):

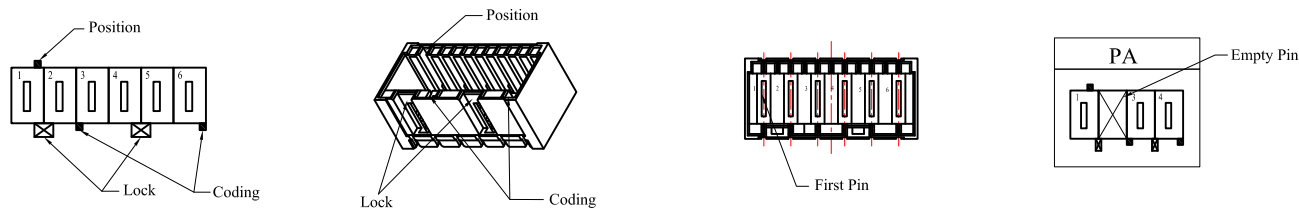

Keying drawings of Housing as below(view from top side):

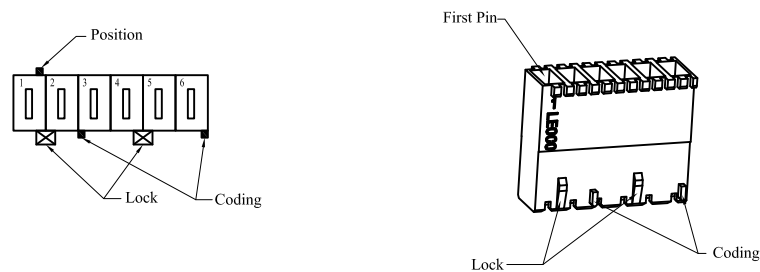

RoHS Compliant

TOLERANCES ARE

MORETHANALL
PCB CONNECTORS
Cable ASSEMBLIES
煜倫股份有限公司

DRAWING BY CY
CHECKED BY GENIUS
UNIT / mm SCALE 1 : 1
DATE
SIZE A4

X, ±
.X ±
.XX ±
.XXX ±
ANG ±

PPOJECTION

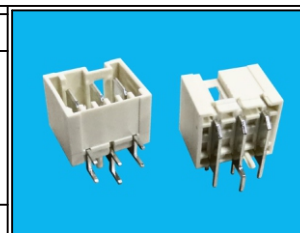

ORDER INFORMATION

RST50-PRBLy-xx0yy-LF

SERIES | KEY LOCK TYPE | LEADFREE
 MALE | 7:7.85 | 02:02WAY
 DIP 90° | 9:9.05 | L TYPE | 12:12WAY
 REVERSE

DESCRIPTION: RAST 5.0 Wafer

www.morethanall.com