

**Mechanical**

Plug Insertion Life: 750 cycles minimum  
 Plug & Jack Contact force: 100 grams minimum using FCC-approved plug  
 Plug Retention Force: 30 lb minimum  
 Temperature: -40° to 150°F (-40 TO 68°)

**Electrical**

Current Rating: 1.5Amps  
 Insulation Resistance: 500 Mohms minimum  
 Contact Resistance: 20 Mohms maximum  
 DC Resistance: 0.1 Mohms maximum  
 Exceed Category 5 Requirements Specified in EIA/TIA TSB-40 Standard SP-2840  
 Data Transmission Rates Up To 100MHz

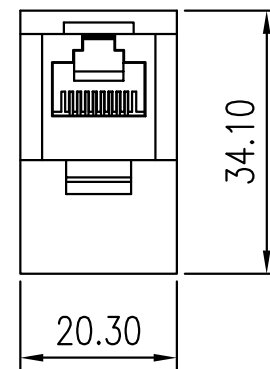
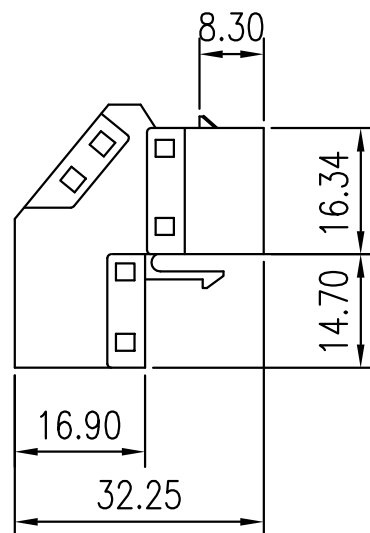
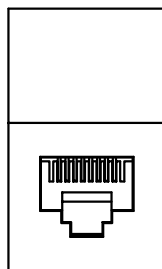
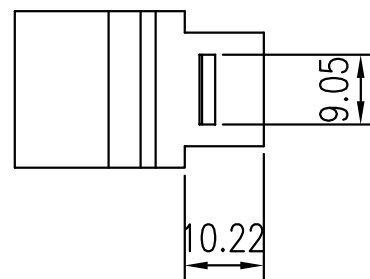

**SPECIFICATION :**

1. HOUSING: ABS UL 94V-0
2. COLOR : WHITE, BLACK
3. CONTACT:  $\phi 0.45$ mm PHOSPHOR BRONZE GOLD PLATING OVER NICKEL.
4. SHIELD: COPPER ALLOY WITH NICKEL PLATED

**RoHS Compliant**

TOLERANCES ARE



煜倫股份有限公司

www.morethanall.com

DRAWING BY CY

CHECKED BY GENIUS

UNIT / mm

SCALE 1 : 1

DATE

SIZE A4

PJECTION

X.  $\pm$   
 .X  $\pm$  0.15  
 .XX  $\pm$  0.10  
 .XXX  $\pm$   
 ANG  $\pm$  0.5°



**ORDER INFORMATION**

RJX2-FLCEPN34FM-0808-LF

SERIES | FEMALE TO FEMALE | L TYPE | CAT.5E | PANEL | LONG 34.1mm | FULL METAL | 8P8C | LEADFREE

DESCRIPTION: PANEL & PLATE IN-LINE COUPLER