

端子材質:BRASS

塑膠材質:NYLON

對插端子:0.8*6.35mm TAB

適用電線:16-14AWG

耐用電壓:105°C 600 VOLTS MAX

包裝數量:1000PCS

表面處理:鍍錫

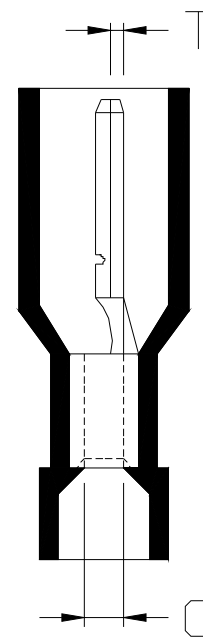
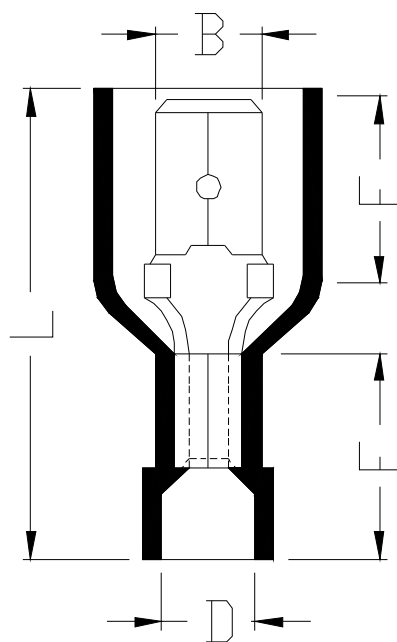
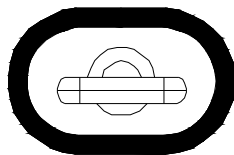

B:6.35±0.2	L:24.0±1.0	F:7.7±0.3	E:11.0±1.0
D:4.5±0.3	C:2.3 ^{+0.3} _{-0.2}	T:0.4±0.03	

RoHS Compliant

TOLERANCES ARE

MORETHANALL
PCB CONNECTORS
Cable ASSEMBLIES

DRAWING BY CY

X, ±

CHECKED BY GENIUS

.X ±

UNIT / mm

SCALE 1 : 1

.XX ±

DATE

.XXX ±

ANG ±

SIZE A4

PPOJECTION



ORDER INFORMATION

Q250-MT8NF-10-LF

SERIES | | | | | LEADFREE

10~12AWG

MALE | | | | | FULL

TERMINAL | | | | | NYLON

0.8mm TAB

煜倫股份有限公司

www.morethanall.com

DESCRIPTION: