

**PCB LAYOUT**

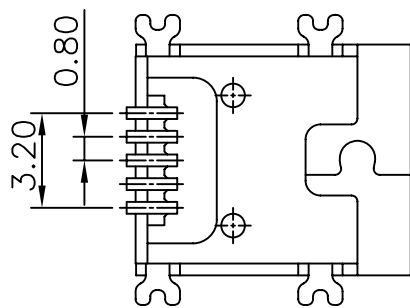
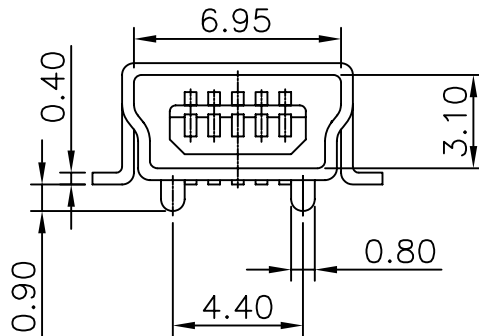
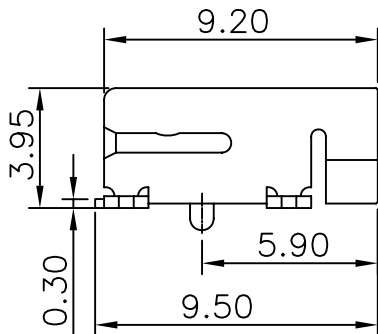

**Material:**

- (1). Insulator : NYLON 9T, UL94V-0.
- (2). Contact : Phosphor Bronze.
- (3). Shell : Brass.
- (4). Finish :  
 Contact = Gold plated on contact area &  
 Tin plated on terminal area  
 Shell = Tin/Lead plated.

MSB-SWS30-5B-LF  
 LEADFREE  
 SEMIGOLD 30u"

RoHS Compliant



PART NO. MSB-SWS30-5B

DWG NO. MSB-SWS30-5B

FILE NO.

UNIT / mm

SCALE 1:1

CHECKED BY CY

DRAWING BY

PROJECTION

TOLERANCES ARE

.X ± 0.2  
 .XX ±  
 .XXX ±  
 AWG

DESCRIPTION:

AREA

REVISIONS

HK

DATE

焜倫股份有限公司