

RECOMMEND P.C.B LAYOUT TOL:±0.05mm

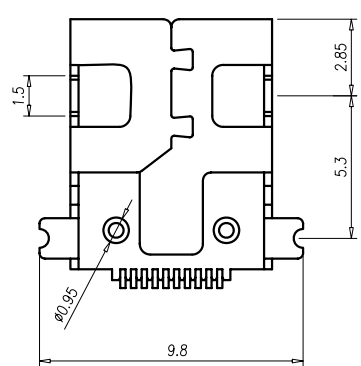
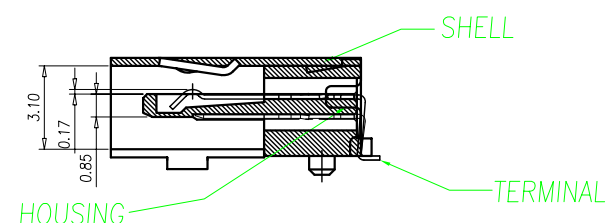
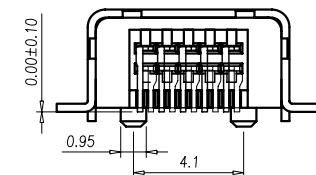
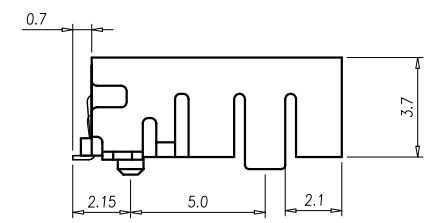
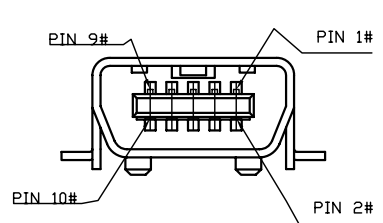

MSB-SWEMPC-10AB-LF
LEADFREE

RoHS Compliant

- NOTE:
- ELECTRICAL PROPERTIES:
 - CONTACT CURRENT RATING:1A AT 250V AC MIN.
 - CONTACT RESISTANCE:50m Ohm MAX
 - INSULATION RESISTANCE:100M Ohm MIN.
 - DIELECTRIC WITHSTANDING VOLTAGE:AC 100V/1 MINUTE.
 - MEASURE ENVIRONMENT:TEMP. 21°C/R.H.55%
 - MATERIAL:
 - CONTACT:PHOSPHOR BRONZE(C5191R-H).
 - HOUSING:LCP
 - SHELL:PHOSPHOR BRONZE(C5191R-H).
 - PLATING:
 - TERMINAL: SEE TABLE, GOLD FLUSH MIN ON SOLDER TAILS, UNDERPLATED NICKEL OVER ALL 50u" MIN.
 - SHELL: NICKEL 60u", SMT GOLD FLUSH ON ALL AREA

MORETHANALL
CONNECTORS
ASSEMBLIES

煜倫股份有限公司

PART NO. MSB-SWEMPC-10AB		CHECKED BY CY	TOLERANCES ARE .X ± 0.2 .XX ± .XXX ± AWG	DESCRIP TION: MINI USB 雙排10PIN(F)AB TYPE(前DIP 後SMT)	AREA	REVISIONS	HK	DATE
DWG NO. MSB-SWEMPC-10AB								
FILE NO.		PROJECTION						
UNIT / mm	SCALE 1:1							