

備註/NOTE:

1. 安規/SAFETY:

- 1-1. Temperature rise: 0.3Aac/30Vac.
- 1-2. Insulation resistance: 500Vac/1min.
- 1-3. Dielectric withstanding voltage: 250Vac/0.5mA/1min.
- 1-4. Low level resistance: full scale voltage 20mV/current 10mA.
- 1-5. Durability: 12000cycles-200mm/min.

2. 材質/MATERIAL:

- 2-1 膠芯/HOUSING: LCP.
- 2-2 端子/PIN: 磷銅/PHOSPHOR BRONZE.
- 2-3 鐵殼/SHELL: 磷銅/PHOSPHOR BRONZE.

3. 電鍍/PLATING:

- 3-1 端子/PIN: GOLD 5u" Δ
- 3-2 鐵殼/SHELL: 霧錫/TIN.

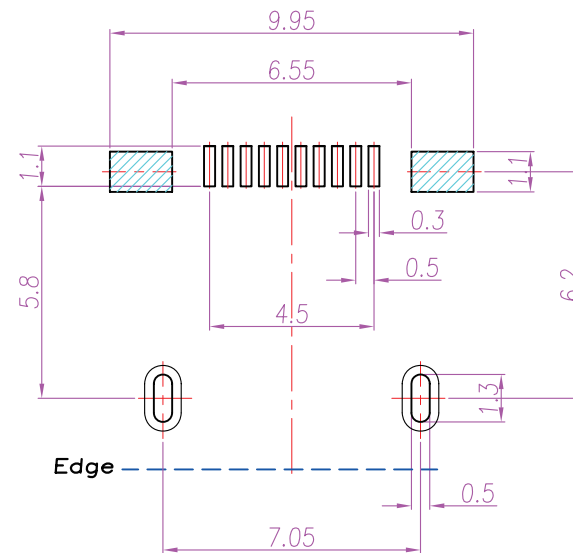
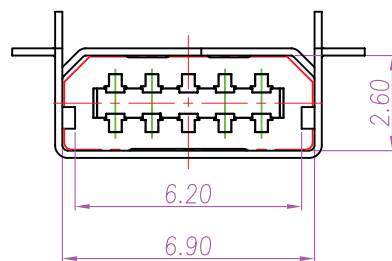
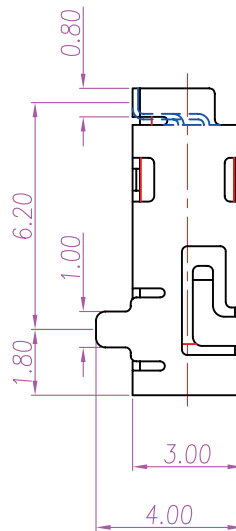
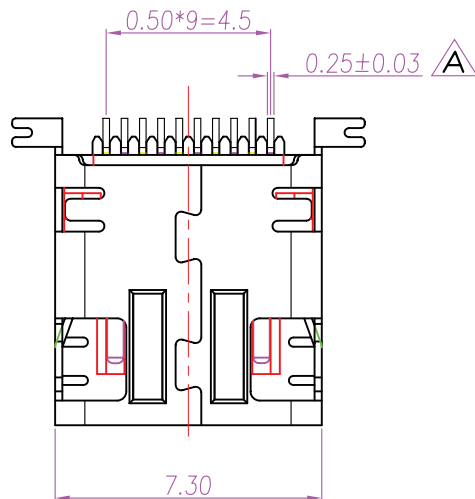
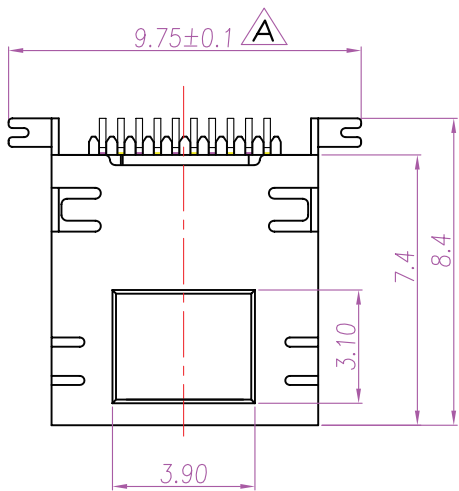

RECOMMEND P.C.B LAYOUT

RoHS Compliant

TOLERANCES ARE

MORETHANALL
PCB CONNECTORS
Cable ASSEMBLIES

煜倫股份有限公司

www.morethanall.com

DRAWING BY CY

CHECKED BY GENIUS

UNIT/mm SCALE 1:1

DATE

SIZE A4

X, ±
.X ±
.XX ±
.XXX ±
ANG ±

PJECTION

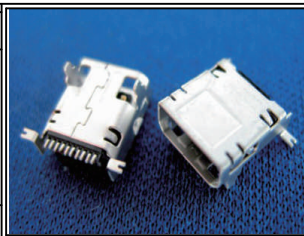

ORDER INFORMATION

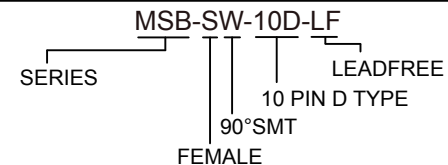

DESCRIPTION: MiniUsb 10(F)板端SMT(鐵殼加深)