

PCB Layout  
(Top View)

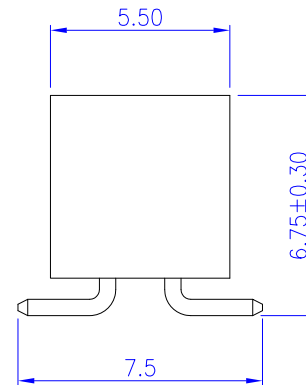

Dimensions			
Pos.	A	B	C
08	10.00	8.85	6.00
10	12.00	10.85	8.00
12	14.00	12.85	10.00
14	16.00	14.85	12.00
16	18.00	16.85	14.00
18	20.00	18.85	16.00
20	22.00	20.85	18.00
24	26.00	24.85	22.00
26	28.00	26.85	24.00
28	30.00	28.85	26.00
30	32.00	30.85	28.00
32	34.00	32.85	30.00
44	46.00	44.85	42.00
50	52.00	50.85	48.00

### Material and Finish

- Housing: Hi-Temp. Plastic (UL94V-0), Black.
- Terminal: Sq. 0.50mm Copper Alloy, Gold Plating.

### Electrical Characteristics

- Current Rating: 1.0 Amp. Max..
- Dielectric Withstand Voltage:  
800V AC RMS for 60Seconds.
- Insulation Resistance:  
1000M Ohms Min. at 500V DC.

### Mechanical Characteristics

- Operating Temperature: -55°C ~ +105°C

照片框

### RoHS Compliant

TOLERANCES ARE

**MORETHANALL**  
PCB CONNECTORS  
Cable ASSEMBLIES

煜倫股份有限公司

www.morethanall.com

DRAWING BY CY

CHECKED BY GENIUS

UNIT / mm

SCALE 1 : 1

DATE

SIZE A4

X, ±  
.X ± 0.30  
.XX ± 0.20  
.XXX ± 0.10  
ANG ±

PPOJECTION

### ORDER INFORMATION

MPVK-VX40-2Xxx-LF

SERIES

180°SMT

LEADFREE

2X04:08 WAY

2X25:50 WAY

GAP 4.0mm

NON POST

DESCRIPTION: 2.00mm Box Header PCB Surface Mount Type Dual Rows (Shorten Type)