

PCB Layout  
(Top View)

### Material and Finish

1. Housing: Nylon 6T (UL94V-0), Black.
2. Terminal: Sq. 0.50mm Copper Alloy, Gold Plating.

### Electrical Characteristics

1. Current Rating: 1.0 Amp. Max..
2. Dielectric Withstand Voltage: 800V AC RMS for 60Seconds.
3. Insulation Resistance: 1000M Ohms Min. at 500V DC.

### Mechanical Characteristics

1. Operating Temperature: -55°C ~ +105°C

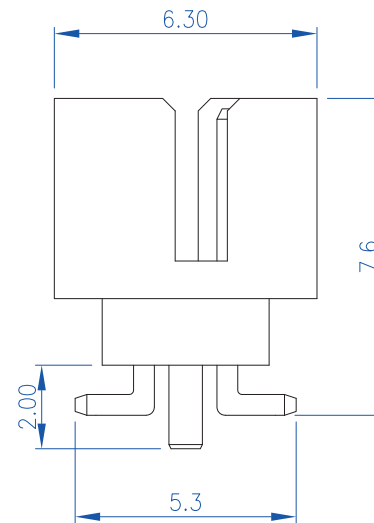
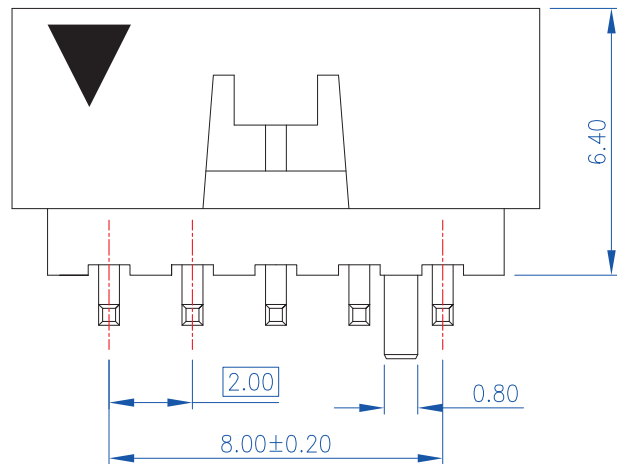

RoHS Compliant

TOLERANCES ARE

**MORETHANALL**  
PCB CONNECTORS  
Cable ASSEMBLIES

煜倫股份有限公司

www.morethanall.com

DRAWING BY CY

CHECKED BY GENIUS

UNIT / mm

SCALE 1 : 1

DATE

SIZE A4

X. ±

.X ±

.XX ±

.XXX ±

ANG ±

PPOJECTION

照片框

ORDER INFORMATION

MPVK-VPLW-2X05-LF

SERIES | | LEADFREE  
| | 10WAY  
| | LOW WINDOW  
POST  
180°SMT

DESCRIPTION: 2.00mm Box Header, Molex Type PCB Surface Mount Type Dual Rows 10P, Single Post