

### Features:

- Finished: Tin-plated
- Thickness: 0.2mm

### Specification:

- Current rating: 5A AC, DC
- Voltage rating: 300V AC, DC
- Dielectric withstanding voltage: 1500V AC/minute
- Ambient temperature range: -25°C ~ 90°C

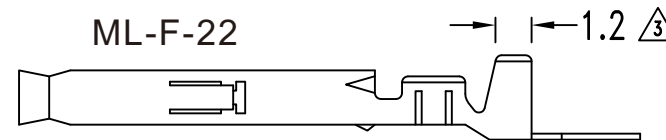
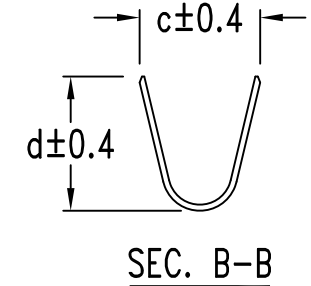
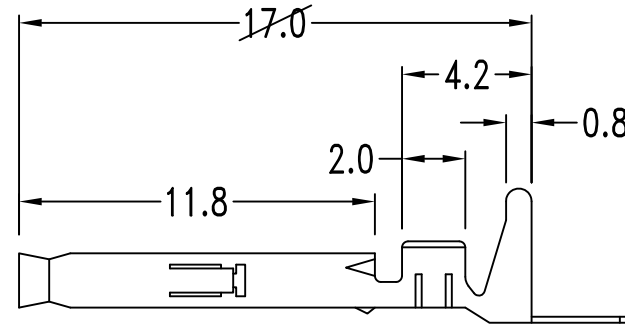
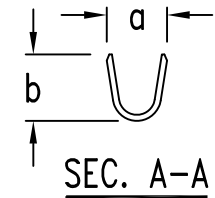
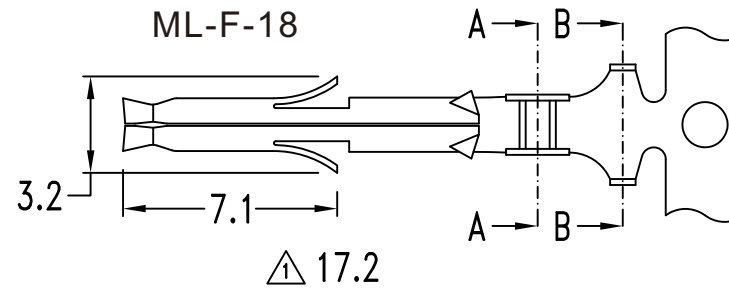

### △ Ordering & Dimensional Information ( mm )

Part No.	Dimension				Wire range	Material
	a	b	c	d		
ML-F-22	1.9	1.6	3.2	2.8	#22 ~ #26	Brass
ML-F-18	2.0	2.2	4.0	4.4	#18 ~ #24	Brass

RoHS Compliant

TOLERANCES ARE

**MORETHANALL**  
PCB CONNECTORS  
Cable ASSEMBLIES  
**煜倫股份有限公司**  
www.morethanall.com

DRAWING BY CY

CHECKED BY GENIUS

UNIT / mm

SCALE 1 : 1

DATE

SIZE A4

PJECTION

X, ±  
.X ± 0.25  
.XX ± 0.15  
.XXX ± 0.05  
ANG ±

照片框

ORDER INFORMATION

ML-F-xx-LF  
SERIES | T LEADFREE  
22:22~26 AWG  
18:18~24 AWG  
FEMALE TERMINAL

DESCRIPTION: .039"(1.0mm) Female Crimp Terminal