

SPECIFICATIONS

Current Rating:

3 Amp

Voltage Rating:

250V

Contact Resistance:

20 m ohms Max.

Insulator resistance:

5000 Megohms Min.

Dielectric withstanding:

AC 500V/minute

Operating Temperature:

-40°~+105°C

Contact Material:

Brass

Insulator Material:

Nylon-6T UL94V-0

Color:Natural

Finish:

Duplex plated:

Gold plated on contact area

Tin on solder area

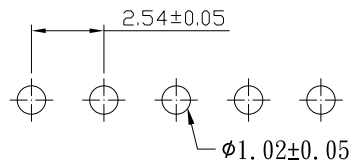
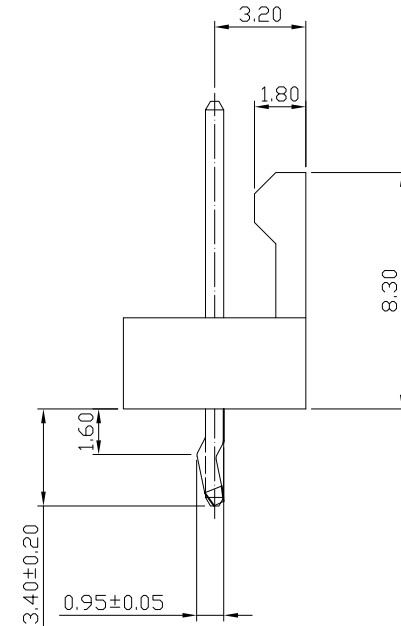
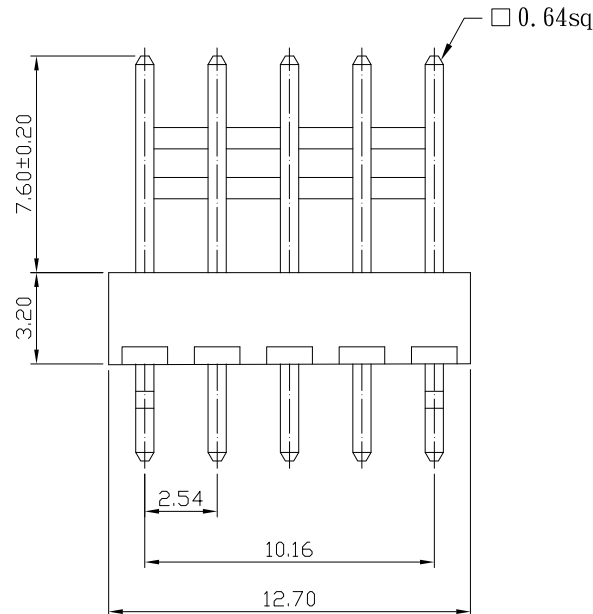
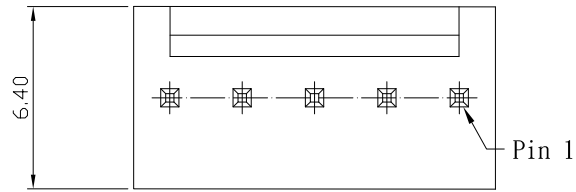

RECOMMENDED P. C. B LAYOUT

RoHS Compliant

TOLERANCES ARE

MORETHANALL
PCB CONNECTORS
Cable ASSEMBLIES

DRAWING BY CY

CHECKED BY GENIUS

UNIT / mm

SCALE 1 : 1

DATE

SIZE A4

P PROJECTION

X, ±
.X ± 0.50
.XX ± 0.25
.XXX ±
ANG ± 3°

照片框

ORDER INFORMATION

MKL-DWHS30-xx-LF
SERIES | LEADFREE
WHITE | 02~08WAY
DIP 90° | SEMI GOLD 30u"

DESCRIPTION:

煜倫股份有限公司

www.morethanall.com