

PCB LAYOUT

MATERIALS:

- HOUSING-DSM STANYL TE250F6 (NYLON-46)
HEAT DEFLECTION TEMP.290°
BLACK COLOR, UL94V-0
- OR-NYLON ZYTEL FR-52
HEAT DEFLECTION TEMP.278°
BLACK COLOR, UL94V-0
- TERMINAL-0.35mm THICK PHOS-BRONZE PLATED
WITH HARD GOLD AND TIN/LEAD
IN SOLDER AREA.
- HOLD DOWN-0.35mm THICK COPPER ALLOY,
PLATED WITH TIN-LEAD.

CAVITY CONFIRMS TO FCC RULES AND REGULATIONS
PART 68,SUBPART F.

COPLANARITY:
THE MAXIMUM DISTANCE
BETWEEN LOWEST AND
HIGHEST PIN WHEN
HOUSING RESTS
ON A FLAT SURFACE

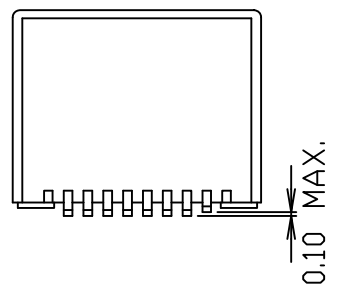

RoHS Compliant

TOLERANCES ARE



煜倫股份有限公司

www.morethanall.com

DRAWING BY CY		X.±
CHECKED BY GENIUS		.X±0.25
UNIT / mm	SCALE 1:1	.XX±0.13
DATE		.XXX±
		ANG±
SIZE A4	PJECTION	

照片框

ORDER INFORMATION

MJW11-KX06NR-0808-LF
 SERIES REEL 8P8C LEADFREE
 BLACK 06u GOLD INNER EAR
 NON POST

DESCRIPTION: 10POS. 8 CONTACTS, SOLDER TAB-INSIDE
LOW PROFILE 1 PORT, SIDE ENTRY SMT TYPE

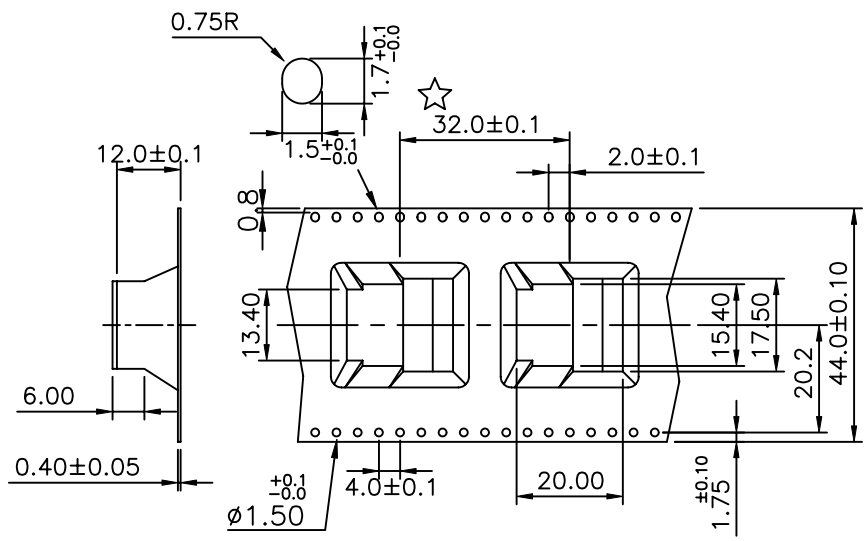

MATERIALS:

- REEL-2mm THICK PLASTIC WHEEL.
- CARRIER-PS (0.40mm THICK TAPE).
- COVER TAPE-PE (0.10mm THICK TAPE).

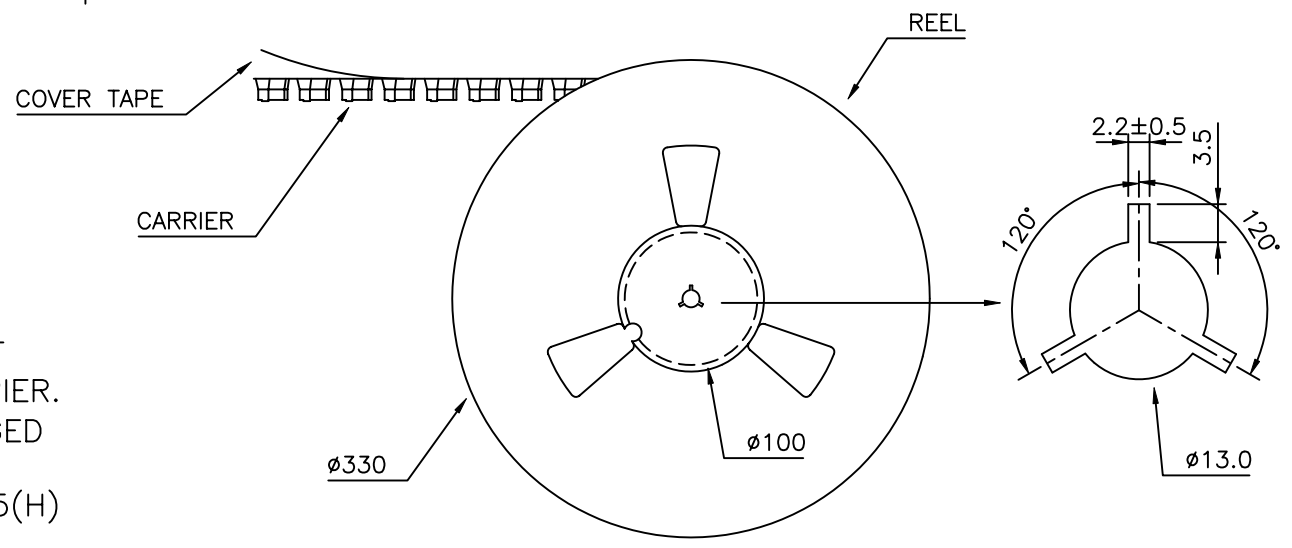
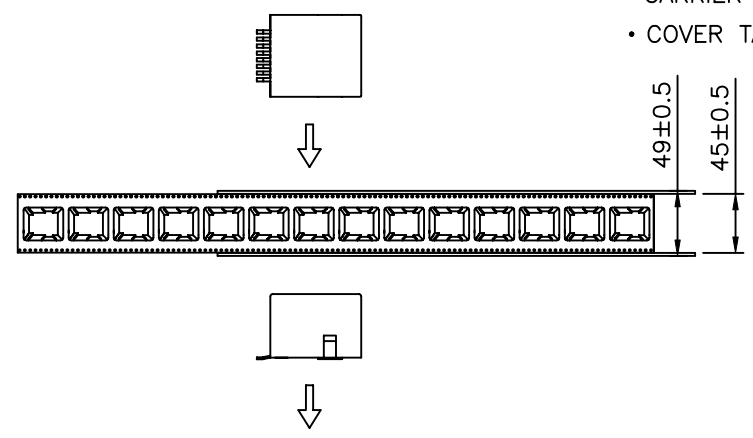

NOTES:

- A. THE DIRECTION OF JACKS PUT INTO CARRIER.
- B. 5 EMPTY CAVITIES FOR BOTH OF TOP AND BOTTOM OF THE CARRIER.
- C. 170 PCS PRODUCTS BE PACKAGED ONE REEL.
- D. CATON SIZE: 345(L)X345(W)X315(H)
6 REEL/CARTON
TOTAL: 1020 PCS

RoHS Compliant

TOLERANCES ARE

MORETHANALL
PCB CONNECTORS
Cable ASSEMBLIES
煜倫股份有限公司
www.morethanall.com

DRAWING BY CY		X. ± .X ± 0.25 .XX ± 0.13 .XXX ± ANG ±
CHECKED BY GENIUS		
UNIT / mm	SCALE 1 : 1	
DATE		
SIZE A4	P PROJECTION	



ORDER INFORMATION

MJW11-KX06NR-0808-LF
SERIES REEL 8P8C LEADFREE
BLACK 06u GOLD NON POST
INNER EAR

DESCRIPTION: TAPE & REEL PACKAGING SPEC.