

LED2 (YELLOW) LED1 (GREEN)

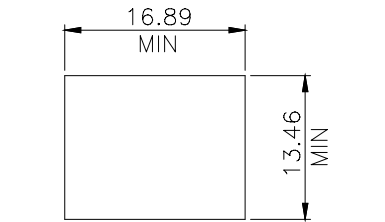

RECOMMENDED PANEL CUTOUT

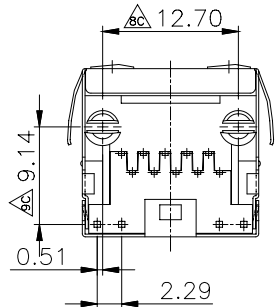
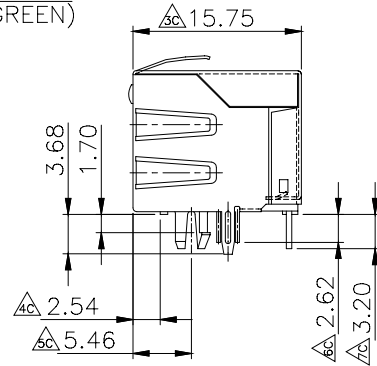
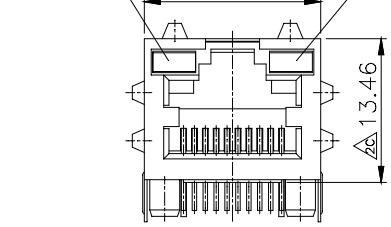
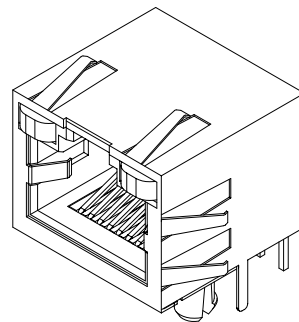
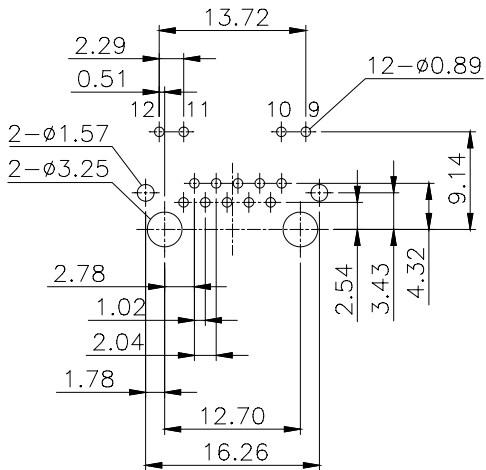

TYPICAL FOR SINGLE COLOR LED (RED, GREEN, YELLOW)

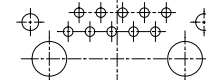
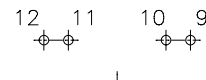
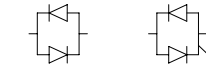
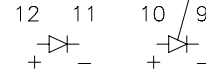

TYPICAL FOR BI-COLOUR LED

GREEN

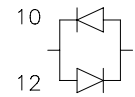

RED

YELLOW

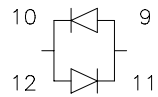

GREEN

BI-COLOUR LED DETAIL  
(GREEN/RED AND YELLOW/GREEN LED'S ARE ALSO AVAILABLE)

MATERIALS:

PLASTIC HOUSING: ENGINEERING THERMOPLASTIC  
FLAMMABILITY RATING UL 94V-0.

CONTACTS: PHOSPHOR BRONZE

PLATING: GOLD PLATING OVER NICKEL IN CONTACT,  
TIN PLATING OVER NICKEL IN SOLDER AREA.

SHIELD: COPPER ALLOY PLATING NICKEL ALLOY.

**MORETHANALL**  
CONNECTORS  
ASSEMBLIES

PART NO. MJF13UL-KF06B3YG-1010

DWG NO. MJF13UL-KF06B3YG-1010

CHECKED BY CY

TOLERANCES ARE

DESCRIPTION:

FILE NO.

DRAWING BY

.X ± 0.2

.XX ±

.XXX ±

AWG

AREA

REVISIONS

HK

DATE

焯倫股份有限公司

UNIT / mm

SCALE 1:1

PROJECTION

