

**SPECIFICATION :**

**1. Electrical Char.**

Insulation Resistance : 500M-Ohm Min.  
 Contact Resistance : 20milli-Ohm Max.  
 Rating Current : 1.5A Max.  
 Rating Voltage : 120V AC  
 Dielectric Voltage : 1,000 Vrms 60 Sec. Min.

**2. Physical char.**

Housing : PBT Glass Filled (UL 94V-0)  
 Color : Black Color  
 Spring Wire : 0.35mm Thickness Phosphor Bronze  
 Nickel Plated and with 50u Gold Plated.  
 Temperature Range : - 25 /+90 Deg C  
 Durability : 500 Mating cycles Min.

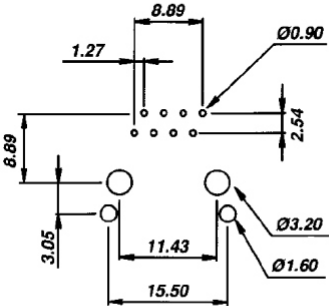
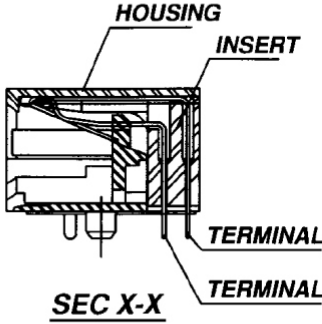
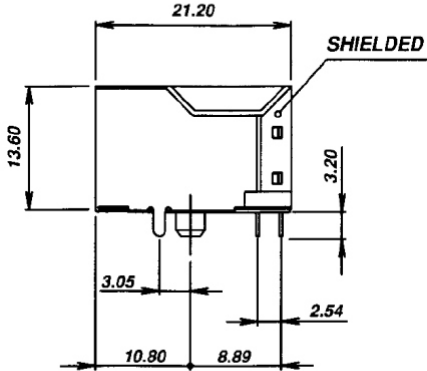
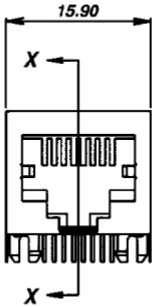

**PCB LAYOUT**  
(Top View)

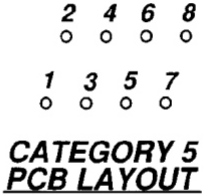
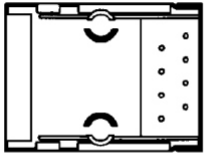

**RoHS Compliant**

TOLERANCES ARE

**MORETHANALL**  
PCB CONNECTORS  
Cable ASSEMBLIES

煜倫股份有限公司

www.morethanall.com

DRAWING BY CY

CHECKED BY GENIUS

UNIT / mm SCALE 1 : 1

DATE

SIZE A4

X, ±  
 .X ±  
 .XX ±  
 .XXX ±  
 ANG ±

PPOJECTION

照片框

ORDER INFORMATION

MJF13C5-KX06A3-0808-LF

SERIES | LEADFREE  
 | 8P8C  
 | FRONT TAB 3.05mm  
 | 06u" GOLD  
 | NON EAR  
 | BLACK

DESCRIPTION: