

**MATERIAL:**

SHIELD: 0.25mm THICKNESS COPPER ALLOY PLATED WITH NICKEL  
 HOUSING: STANDARD MATERIAL GLASS FILLED POLYESTER UL 94V-0  
 STANDARD COLOUR (BLACK)

CONTACTS: 0.45mm PHOSPHOR BRONZE  
 PLATING: SELECTIVE GOLD PLATING

**ELECTRICAL:**

INSULATION RESISTANCE: 500 Mohms MIN  
 DIELECTRIC WITHSTAND VOLTAGE: 1000V RMS MIN, 60 Hz  
 CURRENT/VOLTAGE: 30Vac/42Vdc AT 1.5 AMPS  
 CONTACT RESISTANCE: 40 MILLIOHMS MAX

**MECHANICAL:**

DURABILITY: 1000 MATING CYCLES

PCB LAYOUT/TOP VIEW

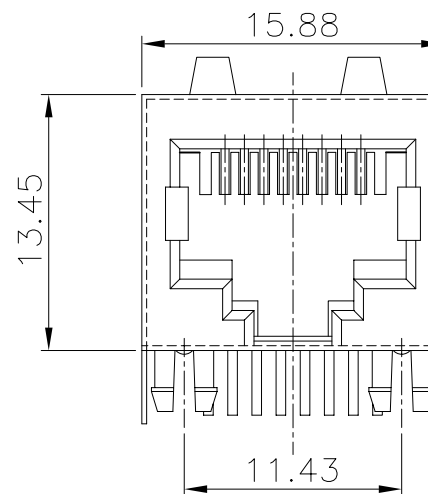
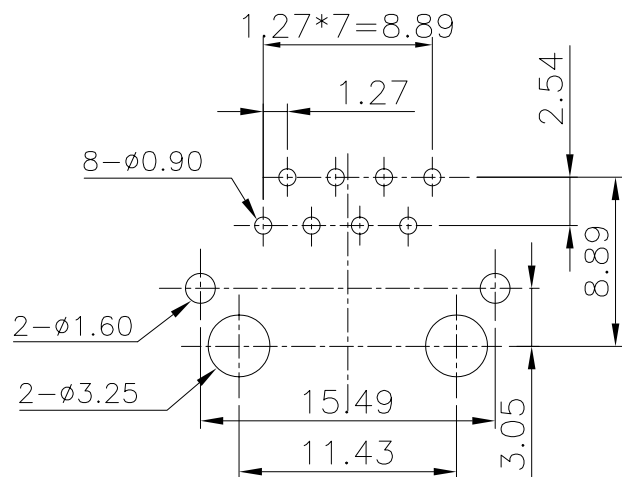

PART NO. **MJF13-KT15B3-0808**

DWG NO. **MJF13-KT15B3-0808**

CHECKED BY CY

TOLERANCES ARE

DESCRIPTION:

1PORTS PCB JACK  
 (SHIELDED,10P8C)

煜倫有限公司

FILE NO.

DRAWING BY

.X ± 0.10  
 .XX ± 0.25  
 .XXX ± 0.38  
 AWG

AREA

REVISIONS

HK

DATE

UNIT / mm

SCALE 1:1

PROJECTION

