

Specifications:

Current rating:3A AC/DC

Voltage Rating:250V AC/DC

Contact Resistance:20m ohm Max

Insulation Resistance:1000M ohm Min

Withstanding Voltage:600V AC For one Minute

Operating Temperature Range:-40°C To +105°C

Materials:

Insulator:PBT (UL94V-0)

Standard Color:Black

Contact:Copper Alloy

Plating:Gold Plated

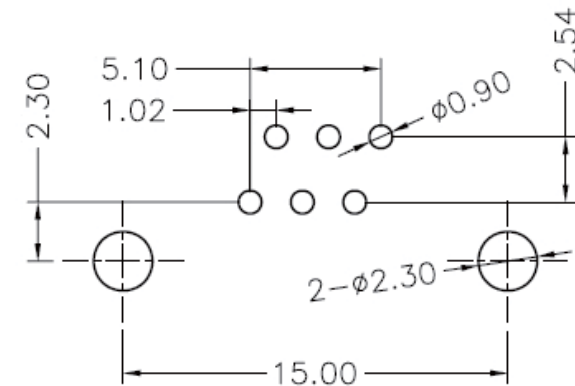

PCB Layout

RoHS Compliant

TOLERANCES ARE

MORETHANALL
PCB CONNECTORS
Cable ASSEMBLIES

DRAWING BY CY

X.±

CHECKED BY GENIUS

.X±

UNIT / mm

SCALE 1:1

.XX±

DATE

.XXX±

ANG±

煜倫股份有限公司

www.morethanall.com

SIZE A4

PPOJECTION

照片框

ORDER INFORMATION

MJ14S15-KX06-0606-LF

SERIES

6P6C

LEADFREE

06u" GOLD

NON POST

BLACK

DESCRIPTION: