

**1. Materials:**

Housing: Hi-Temp. Plastic, UL 94V-0

Shell: SUS, Nickel Plated Overall.

3u" Gold Plated On Solder Tails.

Cu Underplated Overall.

Link: SUS

Spring: SUS

Terminal: Copper Alloy, Gold Plated On Contact Area.

3u" Gold Plated On Solder Tails.

Nickel Plated Under Overall.

**2. Specification:**

Current Rating: 0.5 AMP Max.

Dielectric Withstanding: 500V AC For One Minute

Contact Resistance: 30m Ohms Max.

Insulation Resistance: 1000M Ohms Min At DC 500V

Operation Temperature: -25°C ~ +85°C

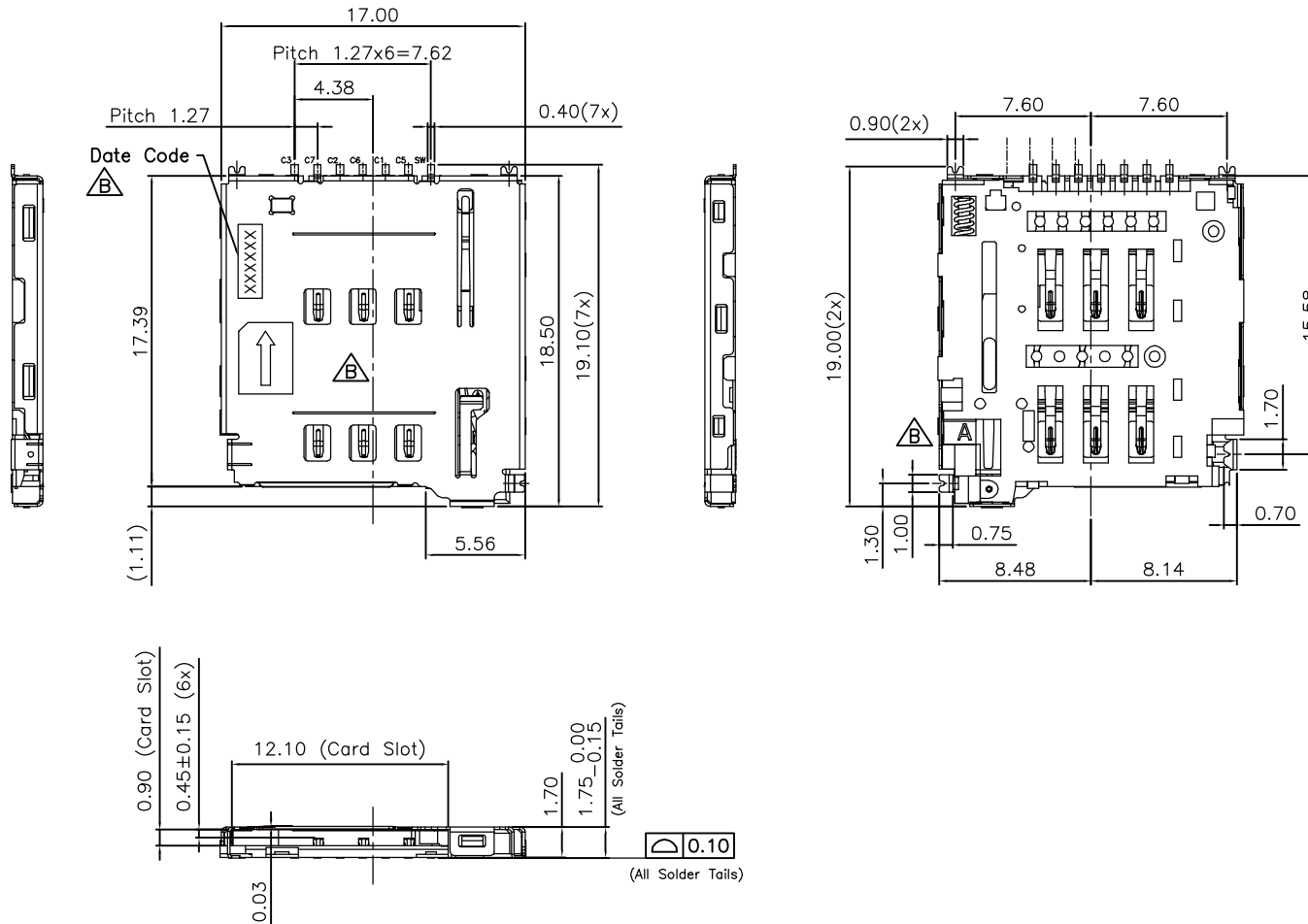

Circuit Diagram for Detect Switch

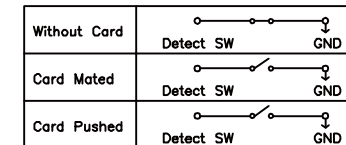

**RoHS Compliant**

TOLERANCES ARE

**MORETHANALL**  
PCB CONNECTORS  
Cable ASSEMBLIES

DRAWING BY CY

X, ±

CHECKED BY GENIUS

.X ± 0.30

UNIT / mm

SCALE 1 : 1

.XX ± 0.20

DATE

.XXX ± 0.10

ANG ± 3°

照片框

**ORDER INFORMATION**

MISCP-W15E17AR-06-LF



煜倫股份有限公司

www.morethanall.com

SIZE A4

PPOJECTION

DESCRIPTION: MICRO SIM CARD, 6 PIN, SMT,METALSHIELD, PUSH-PUSH TYPE, FEMALE

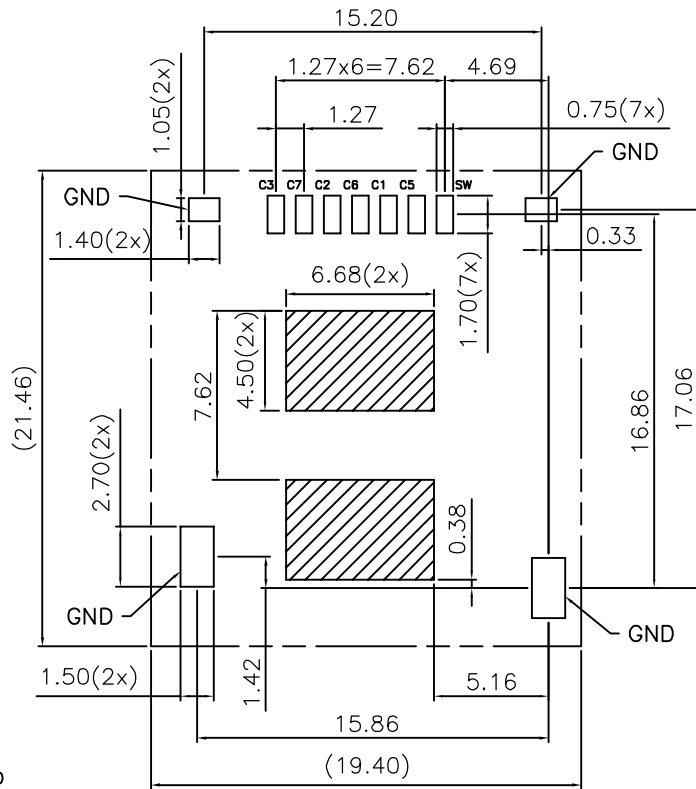
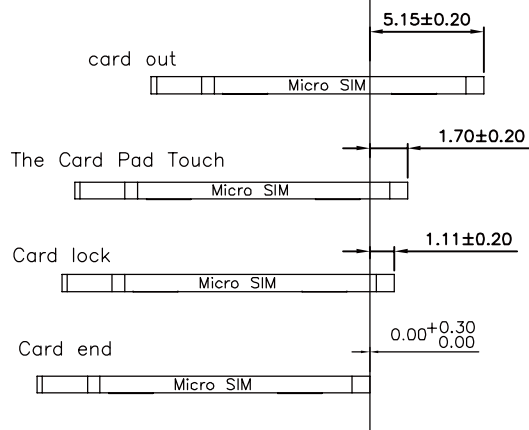
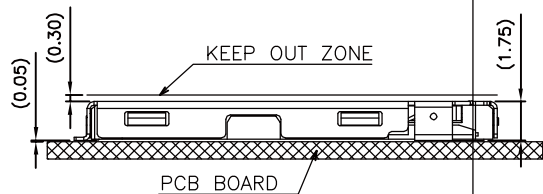
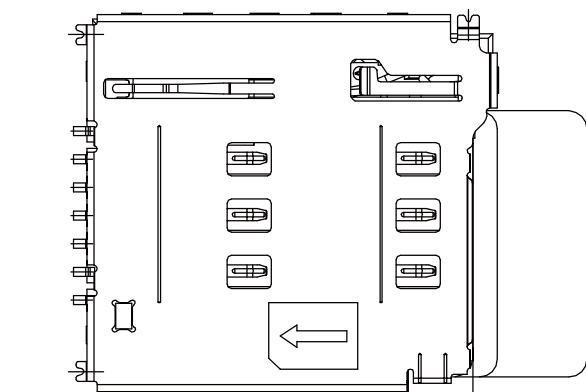

Recommended PCB Layout

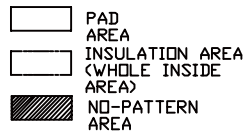

Micro SIM COMMON DIMENSIONS			
SYMBOL	MIN	NOM	MAX
L	14.90	15.00	15.10
W	11.90	12.00	12.10
T	0.68	0.76	0.84

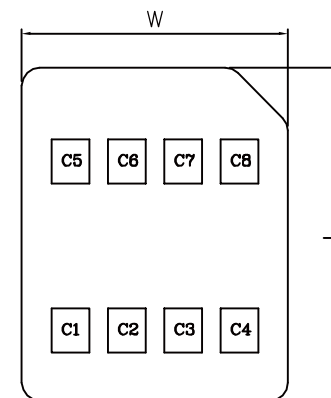

Micro SIM CARD

Pin No.	NAME
C1	VCC
C2	RST
C3	CLK
C4	Reserved
C5	GND
C6	VPP
C7	I/O
C8	Reserved

RoHS Compliant

TOLERANCES ARE

**MORETHANALL**  
PCB CONNECTORS  
Cable ASSEMBLIES

DRAWING BY CY

X, ±

CHECKED BY GENIUS

.X ± 0.30

UNIT / mm

SCALE 1 : 1

.XX ± 0.20

DATE

.XXX ± 0.10

ANG ± 3°

SIZE A4

PPOJECTION

照片框

ORDER INFORMATION

MISCP-W15E17AR-06-LF

SERIES

LEADFREE

06 WAY

REEL

SWITCH CLOSED

1.75mm HIGH

90°SMT

EAR WIDTH 15.58mm

煜倫股份有限公司

www.morethanall.com

DESCRIPTION: MICRO SIM CARD, 6 PIN, SMT,METALSHIELD, PUSH-PUSH TYPE, FEMALE

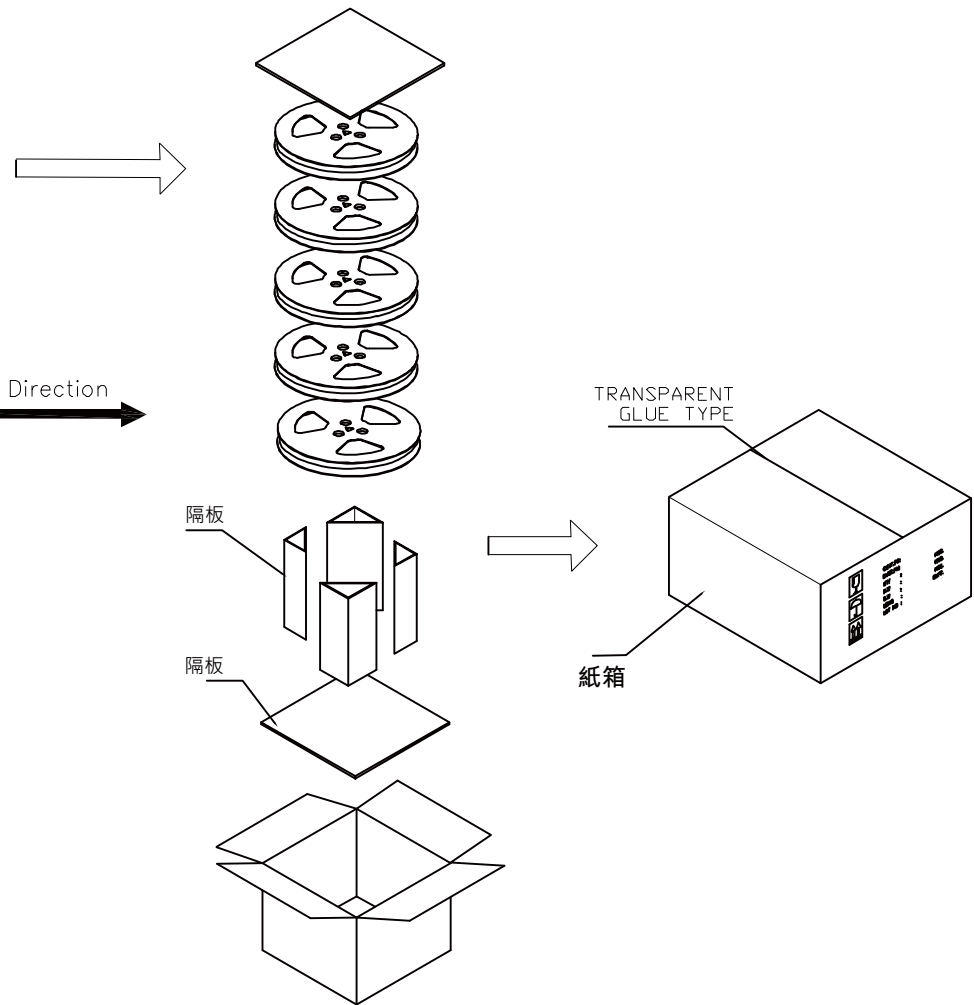
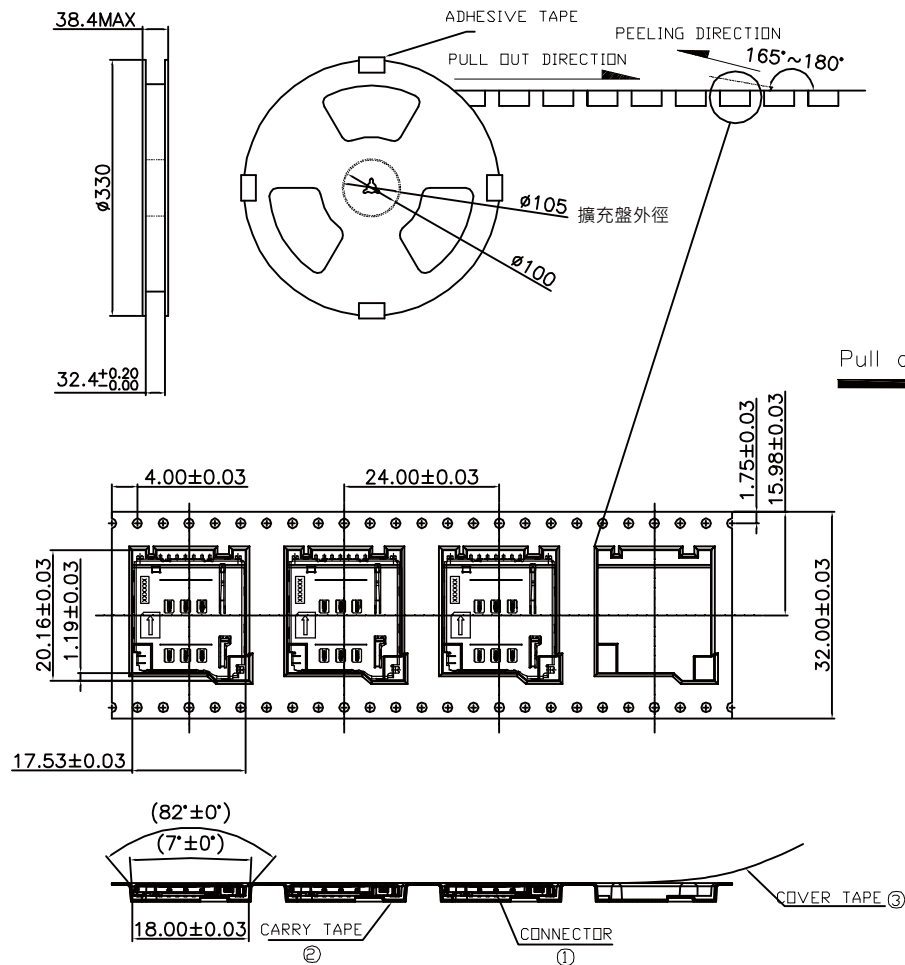

20PCS TAIL PART (EMPTY)	1000 PCS COMPONENT SUPPLIER	20PCS LEADER PART (EMPTY)
-------------------------------	-----------------------------------	---------------------------------

Part No.	Reel/PCS	Carton/Reel	Carton/PCS
MISCP-W15E17AR-08	1/1000	1/5	1/5000

**RoHS Compliant**

TOLERANCES ARE

**MORETHANALL**  
PCB CONNECTORS  
Cable ASSEMBLIES

DRAWING BY CY

CHECKED BY GENIUS

UNIT / mm

SCALE 1 : 1

DATE

SIZE A4

X, ±  
.X ± 0.30  
.XX ± 0.20  
.XXX ± 0.10  
ANG ± 1°

PPOJECTION

照片框

**ORDER INFORMATION**

MISCP-W15E17AR-06-LF

SERIES | | | | | LEADFREE  
| | | | | 06 WAY  
| | | | | REEL  
| | | | | SWITCH CLOSED  
90°SMT | | | | | 1.75mm HIGH  
| | | | | EAR WIDTH 15.58mm

煜倫股份有限公司

www.morethanall.com

DESCRIPTION: MICRO SIM CARD, 6 PIN, SMT, METALSHIELD, PUSH-PUSH TYPE, FEMALE