

Notes:

1. Materials
  - a. Housing: LCP+30% G/F, Black, UL94 V-0;
  - b. Contact: Phosphor Copper (C5191), Gold Plating at mating area, Matte Tin or Au Plating at solder tail, all overNickel;
  - c. Shell: Phosphor Copper (C5191);
2. Ratings
  - a. Current Rating: 0.3A ;
  - b. Operating Temperature: -40°C ~ 85°C;
3. Electrical Requirement:
  - a. LLCR: Excluding Conductor Resistance 10mΩ Max.(Target design value),  
Contact: 30mΩ Max. changed (Final), Shell: 50mΩ Max. Changed (Final);
  - b. Dielectric Withstanding Voltage: 150V AC (RMS) for 1 minute (Mated), 250V AC (RMS) for 1 minute (Unmated);
  - c. Insulation Resistance: 10MΩ Min. @ 150V DC (Mated), 100MΩ Min. @ 500V DC (Unmated);
54. Mechanical Performance:
  - a. Insertion force: 44.1N (4.5Kgf) Max.;
  - b. Withdrawal force: 4.9~25N (0.5~2.5Kgf);
  - c. Durability life: 5,000 Cycles;
5. IR Reflow: the peak temperature on board shall be maintained for 10 seconds at 260±5°C.

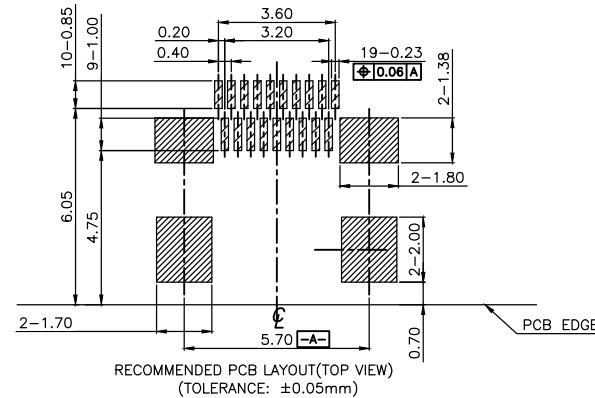

PIN	Signal Assignment
1	Hot Plug Detect
2	Utility
3	TMDS Data2+
4	TMDS Data2 Shield
5	TMDS Data2-
6	TMDS Data1+
7	TMDS Data1 Shield
8	TMDS Data1-
9	TMDS Data0+
10	TMDS Data0 Shield
11	TMDS Data0-
12	TMDS Clock+
13	TMDS Clock Shield
14	TMDS Clock-
15	CEC
16	DDC/CEC Ground
17	SCL
18	SDA
19	+5V Power

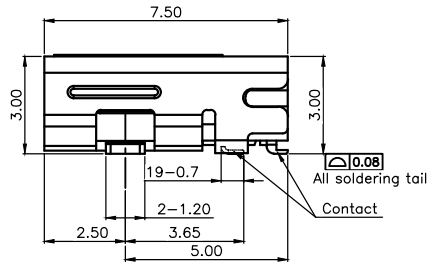
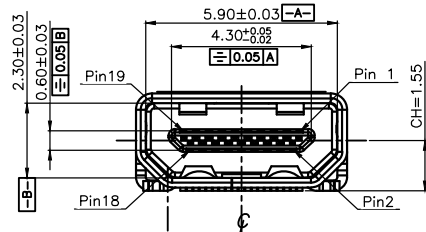
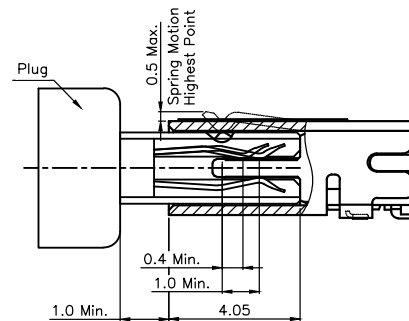
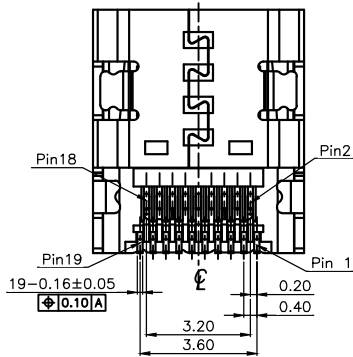

Receptacle and Plug Mated Condition

RoHS Compliant

TOLERANCES ARE

**MORETHANALL**  
PCB CONNECTORS  
Cable ASSEMBLIES

DRAWING BY CY

CHECKED BY GENIUS

UNIT / mm

SCALE 1 : 1

DATE

SIZE A4

PPOJECTION

X, ±  
.X ± 0.30  
.XX ± 0.25  
.XXX ± 0.15  
ANG ±

照片框

ORDER INFORMATION

MIHDMI-SWJJCR-19-LF

SERIES | | | | LEADFREE  
19 WAY  
REEL  
MYLAR  
JJ TYPE  
FEMALE | | | | 90°SMT

煜倫股份有限公司

www.morethanall.com

DESCRIPTION: HDMI Type D 19Pin,板上型 CH=1.55,双排SMT,外壳全贴5.7

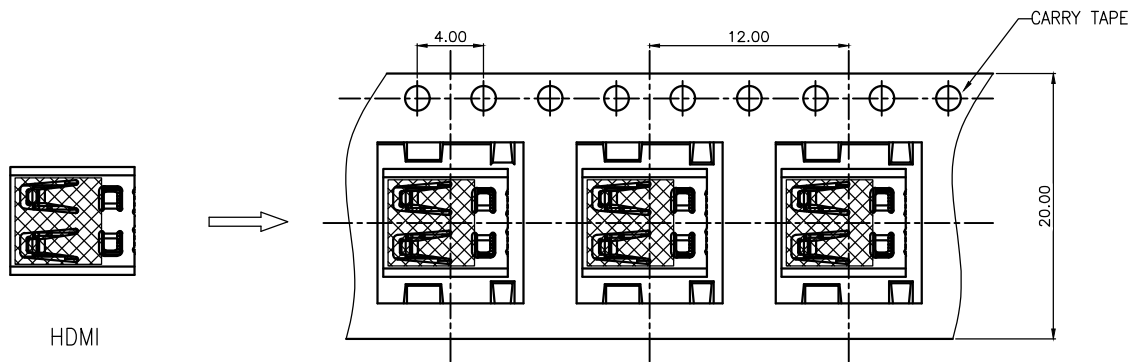
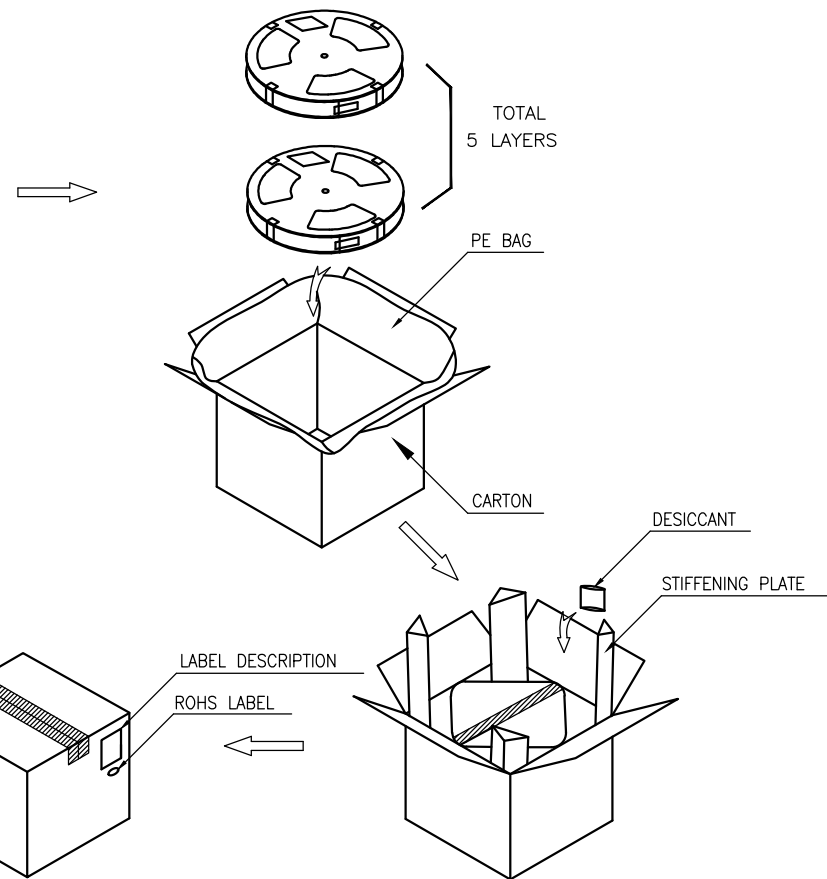
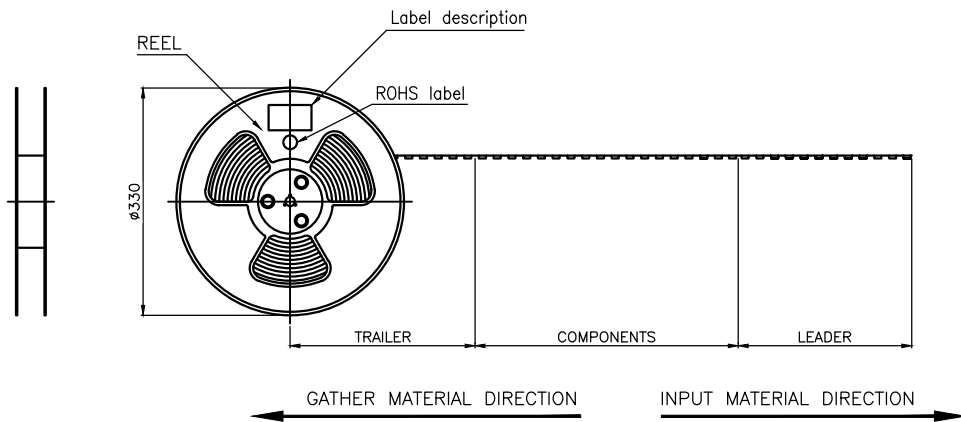

Notes:

1. The start and end of each reel, based on the actual quantity, reserved 10--15pcs space;
2. Peel off force of top tape: 10g~130g, peel deg.:165°~175°; peel speed: 250~300mm/min;
3. Carton size: 350\*350\*155mm.
4. QTY: 1000pcs/reel, 5reel/carton, total 5000pcs/carton;

RoHS Compliant

TOLERANCES ARE

**MORETHANALL**  
PCB CONNECTORS  
Cable ASSEMBLIES

DRAWING BY CY

CHECKED BY GENIUS

UNIT / mm

SCALE 1 : 1

DATE

SIZE A4

X, ±  
.X ± 0.30  
.XX ± 0.25  
.XXX ± 0.15  
ANG ±

PPOJECTION

照片框

ORDER INFORMATION

MIHDMI-SWJJCR-19-LF

SERIES | | | | | LEADFREE  
19 WAY  
REEL  
MYLAR  
JJ TYPE  
FEMALE 90°SMT

煜倫股份有限公司

www.morethanall.com

DESCRIPTION: HDMI Type D 19Pin,板上型 CH=1.55,双排SMT,外壳全贴5.7