

Features:

- 2 ~ 24 circuits available
- 600V volts rating
- Current rating up to 9 amperes per circuits
- Positive housing locks & Fully isolated terminals
- Low encasement force terminals
- Material: nylon 66 UL 94V-0

Specification:

- Current rating and wire size:

Wire Size AWG	Circuits			
	2	4, 6	8, 10	12~24
# 16	9 A	8 A	7 A	6 A
# 18	9 A	8 A	7 A	6 A
# 20	7 A	6 A	5 A	5 A
# 22	5 A	4 A	4 A	4 A
# 24	4 A	3 A	3 A	3 A
# 26	3 A	2 A	2 A	2 A
# 28	2 A	1 A	1 A	1 A

- Voltage rating: 600V (R.M.S.)
- Insulation resistance: DC 500V 1000M Ω min.
- Dielectric withstanding voltage: 1500V AC/minute
- Ambient temperature range: -25°C ~ 85°C

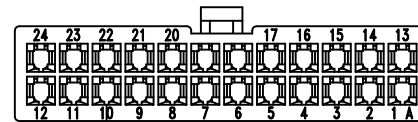
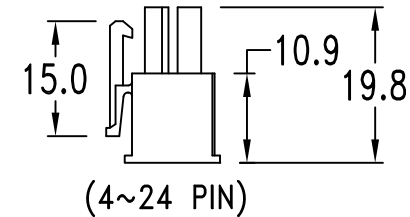
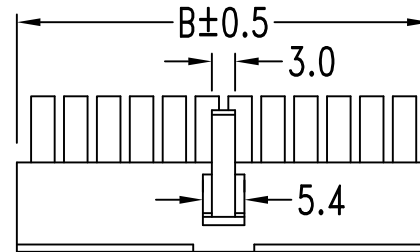

Dimensional Information (mm)

Circuits	Dim. A	Dim. B	Circuits	Dim. A	Dim. B	Circuits	Dim. A	Dim. B
2		5.6	10	16.8	22.4	18	33.6	39.2
4	4.2	9.8	12	21.0	26.6	20	37.8	43.4
6	8.4	14.0	14	25.2	30.8	22	42.0	47.6
8	12.6	18.2	16	29.4	35.0	24	46.2	51.8

RoHS Compliant

TOLERANCES ARE

MORETHANALL
PCB CONNECTORS
Cable ASSEMBLIES

煜倫股份有限公司

www.morethanall.com

DRAWING BY CY

CHECKED BY GENIUS

UNIT / mm SCALE 1 : 1

DATE

SIZE A4

PJECTION

X, \pm
.X \pm 0.40
.XX \pm 0.25
.XXX \pm 0.08
ANG \pm

照片框

ORDER INFORMATION

MF-SHV0-2Xxx-LF
SERIES | LEADFREE
2X01:02WAY
2X12:24WAY
UL 94V0
HOUSING
FEMALE

DESCRIPTION:

2P

4P

6P

8P

10P

12P

14P

16P

18P

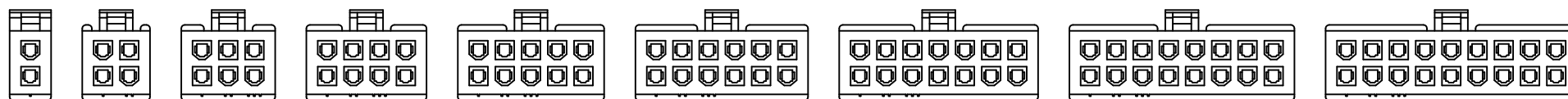

20P

22P

24P

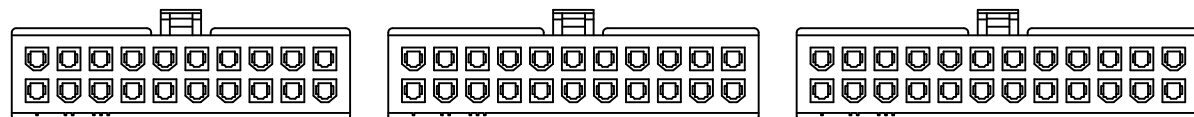

RoHS Compliant

TOLERANCES ARE

MORETHANALL
 PCB CONNECTORS
 Cable ASSEMBLIES

煜倫股份有限公司

www.morethanall.com

DRAWING BY CY

CHECKED BY GENIUS

UNIT / mm

SCALE 1 : 1

DATE

SIZE A4

X, ±
 .X ± 0.40
 .XX ± 0.25
 .XXX ± 0.08
 ANG ±

P PROJECTION

照片框

ORDER INFORMATION

MF-SHV0-2Xxx-LF
 SERIES | LEADFREE
 | 2X01:02WAY
 | 2X12:24WAY
 | UL 94V0
 | HOUSING
 | FEMALE

DESCRIPTION: