

A-A SECTION

■ TERMINAL

- Material: Phos. bronze
- Thickness: 0.2mm
- Plating: Tin plated 60u"
- Wire Range: Suitable for AWG#22~28
- Insulation O.D: 1.7mm(max)
- Q'TY: 15,000 pcs/roll

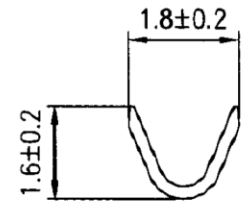
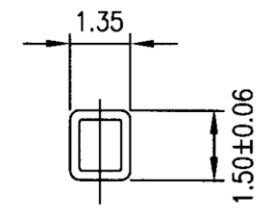
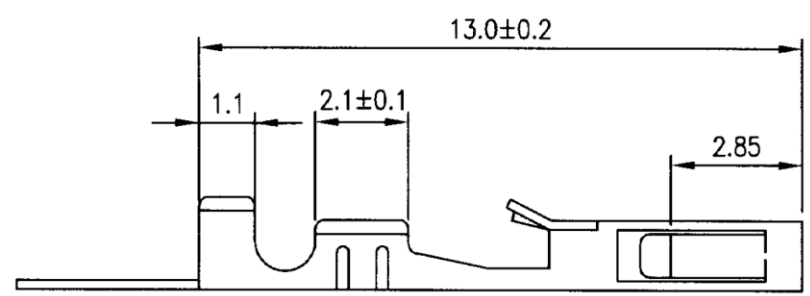

B-B SECTION

RoHS Compliant

TOLERANCES ARE



DRAWING BY CY

CHECKED BY GENIUS

UNIT / mm SCALE 1 : 1

DATE

SIZE A4

- X. ±
- .X ±
- .XX ±
- .XXX ±
- ANG ±

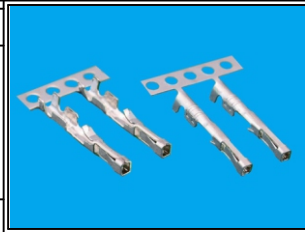

ORDER INFORMATION

MCT-T-22-LF
 SERIES | T LEADFREE
 22 AWG
 TERMINAL

煜倫股份有限公司

www.morethanall.com

PPOJECTION

DESCRIPTION: