

RECOMMENDED P.C.B LAYOUT

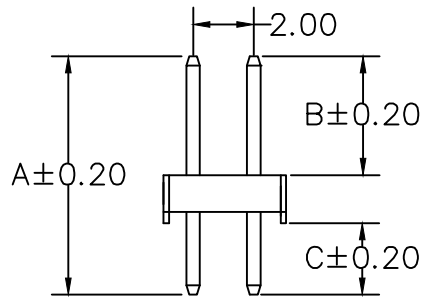
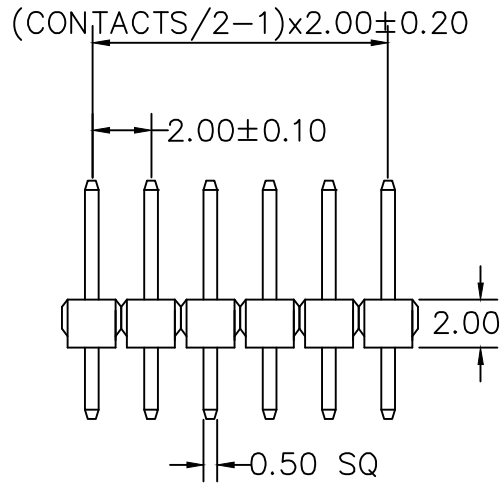

A: 9.80 mm B: 5.00 mm C: 2.80 mm

M-D5028-2Xxx-LF  
LEADFREE

RoHS Compliant

|          |      |
|----------|------|
| CONTACTS | 2X21 |
| 2X2      | 2X22 |
| 2X3      | 2X23 |
| 2X4      | 2X24 |
| 2X5      | 2X25 |
| 2X6      | 2X26 |
| 2X7      | 2X27 |
| 2X8      | 2X28 |
| 2X9      | 2X29 |
| 2X10     | 2X30 |
| 2X11     | 2X31 |
| 2X12     | 2X32 |
| 2X13     | 2X33 |
| 2X14     | 2X34 |
| 2X15     | 2X35 |
| 2X16     | 2X36 |
| 2X17     | 2X37 |
| 2X18     | 2X38 |
| 2X19     | 2X39 |
| 2X20     | 2X40 |

MATERIAL  
HOUSING : THERMOPLASTIC UL94V-0  
CONTACT : COPPER ALLOYS

SPECIFICATION  
CURRENT: 1A  
OPERATING TEMPERATURE: -55°C TO +105°C  
CONTACT RESISTANCE : 20 MILLIOHMS MAX  
INSULATION RESISTANCE : 5000 MEGAOHMS MIN  
DIELECTRIC STRENGTH : 1000 VAC MIN

**MORETHANALL**  
CONNECTORS  
ASSEMBLIES

|                       |           |               |  |               |      |           |    |      |
|-----------------------|-----------|---------------|--|---------------|------|-----------|----|------|
| PART NO. M-D5028-2Xxx |           | CHECKED BY CY | TOLERANCES ARE<br>.X ±<br>.XX ±<br>.XXX ±<br>AWG | DESCRIP TION: | AREA | REVISIONS | HK | DATE |
| DWG NO. M-D5028-2Xxx  |           |               |  |               |      |           |    |      |
| FILE NO.              |           | DRAWING BY    |  |               |      |           |    |      |
| UNIT / mm             | SCALE 1:1 | PROJECTION    |  |               |      |           |    |      |

煜倫股份有限公司