

- * Housing Material:
UL94V-0 Glass fiber
reinforce polysester
- * Contact Matrerial:
Brass
- * Current Rating:
3 Amp (1600VAC)
- * Contact Resistance:
Less than 10 milliohms
- * Insulation Resistance:
Over 1000 Ω 500VDC/1 min
- * Operation Temperature:
-55°C ~ +120°C
- * Operation Relative:
Humidity : 5 to 95% R.H.

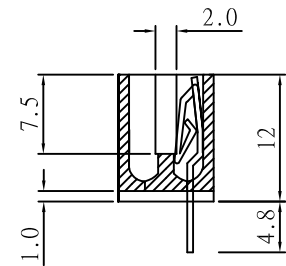
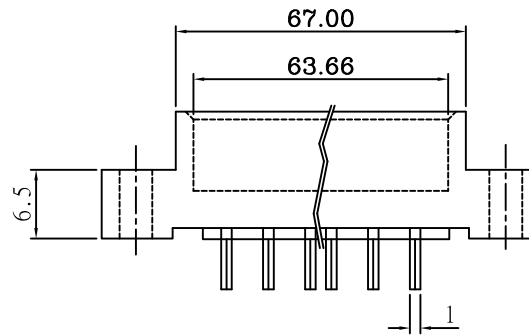
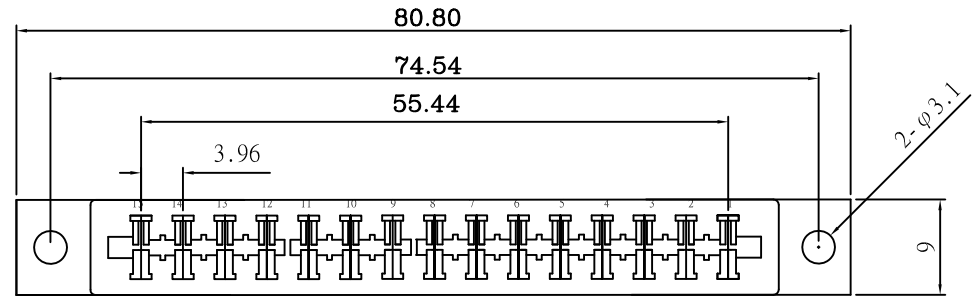

RoHS Compliant

TOLERANCES ARE

MORETHANALL
PCB CONNECTORS
Cable ASSEMBLIES

DRAWING BY CY

X. \pm

CHECKED BY GENIUS

.X \pm

UNIT / mm

SCALE 1 : 1

.XX \pm

DATE

.XXX \pm

ANG \pm

SIZE A4

PPOJECTION

照片框

ORDER INFORMATION

KE-DLE-1X15M811-LF
 SERIES | 15 WAY | LEADFREE
 LOW EAR | MLD KEY 8+11
 DIP 180°

DESCRIPTION:

煜倫股份有限公司

www.morethanall.com