

說明:
 1.預鍍錫膜厚40μ以上
 2.對手件: TAB=0.8
 插入力:1.2kg以下
 拉拔力:0.2-0.5kg以上

NOTE:
 1.Tre-Tin Plated Thickness More Than 40μ.
 2.Mating Part:Tab=0.8
 Inserted Force: Less Than 1.2kgf.
 Tensile Force: 0.2-0.5kgf

JT-FT-16-LF
 LEADFREE
 RoHS Compliant

I	Phosphor Bronze	Note 1	0.5-1.25mm ²
NO.	材料	表面處理	線徑
	Material	Surface Treatment	Wire Range

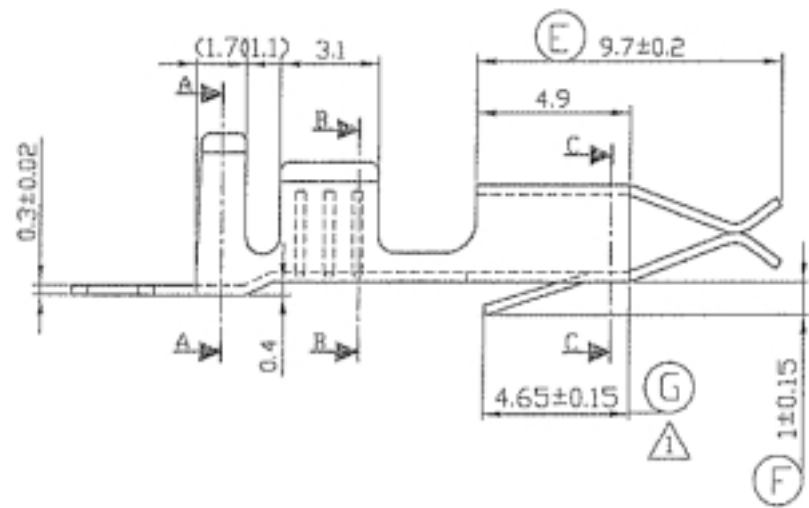

MORETHANALL
 CONNECTORS
 ASSEMBLIES

煜倫股份有限公司

PART NO. JT-FT-16		CHECKED BY CY	TOLERANCES ARE .X ± 0.2 .XX ± .XXX ± AWG	DESCRIP TION:			
DWG NO. JT-FT-16							
FILE NO.		PROJECTION	AREA	REVISIONS	HK	DATE	
UNIT / mm	SCALE 1:1						