

SEC.A-A

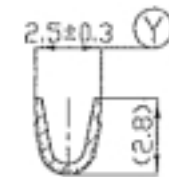

SEC.B-B

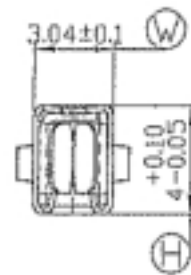
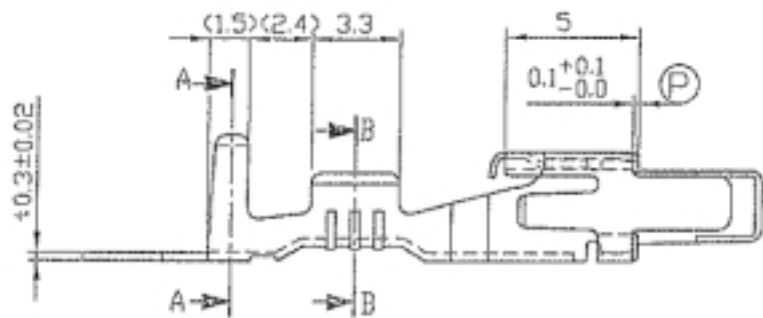

說明:
 1.預鍍銅膜厚40μm以上
 2.對手件:TAB=0.8
 插入力:1.3KG以下
 拉拔力:0.4KG以上
 6回拉力:0.2KG以上

NOTE:
 1.Pre-Tin Plated Thickness More Than 40μm
 2.Mating Part:TAB=0.8
 Inserted Force: Less Than 1.3KG
 Tensile Force: More Than 0.4KG
 The Sixth Time : More Than 0.2KG

JPT-FT-16-LF
 LEADFREE
 RoHS Compliant

1	Body:Phosphor Bronze Spring:Stainless/Steel	Note 1	0.5~1.25mm ²
NO.	材料 Material	表面處理 Surface Treatment	線徑 Wire Range

MORETHANALL
 CONNECTORS
 ASSEMBLIES

焜倫股份有限公司

PART NO. JPT-FT-16

DWG NO. JPT-FT-16

FILE NO.

UNIT / mm

SCALE 1:1

CHECKED BY CY

DRAWING BY

PROJECTION

TOLERANCES ARE

.X ± 0.2
 .XX ±
 .XXX ±
 AWG

DESCRIP TION:

AREA

REVISIONS

HK

DATE