

• **MATERIALS:(RoHS Compliant)**

Housing: Plastic Thermoplastic
P.B.T UL94V-0 Black

Contacts: Phosphor Bronze Gold
Selective Plated

Front Shell: Steel Nickel Plated
Over Copper

• **ELECTRICAL CHARACTERISTICS:**

Contact Current Rating: 1 Amp

Dielectric Withstanding Voltage: 500V AC

Insulation Resistance: >500MΩ/Min

Contact Resistance: 35mΩ/Max

Operation Temperature: -55°C ~ +105°C

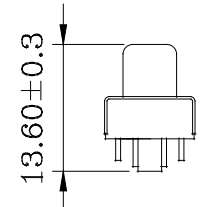
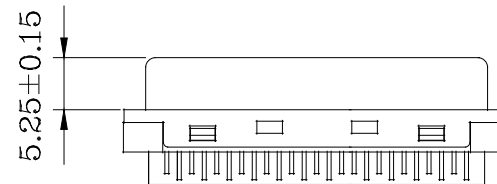
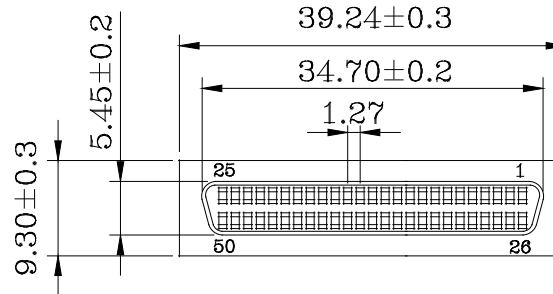

RoHS Compliant

TOLERANCES ARE

MORETHANALL
PCB CONNECTORS
Cable ASSEMBLIES

DRAWING BY CY

CHECKED BY GENIUS

UNIT / mm

SCALE 1:1

DATE

SIZE A4

PJECTION

X.±
.X±
.XX±
.XXX±
ANG±

照片框

ORDER INFORMATION

HPD-SS-050-LF
SERIES | LEADFREE
050 WAY
SOLDER
FEMALE

煜倫股份有限公司

www.morethanall.com

DESCRIPTION:

1.27mm (.050") Pin Type 50Pos Cable Receptacles
Connector Solder Assembly Type