

NOTE:
 CONNECTOR ELECTRICAL CHARACTERISTICS:
 1. CONTACT CURRENT RATING: 1.0 AMPERE
 2. DIELECTRIC WITHSTANDING VOLTAGE: AC 500 V r.m.s
 3. INSULATION RESISTANCE: 500 MEGOHMS Min
 4. CONTACT RESISTANCE: 35 MILLIOHMS Max.

MATERIAL:
 1. CONTACT: COPPER ALLOY
 2. INSULATOR: THERMOPLASTIC WITH GLASS-FIBER FILLED UL 94V-0 RATED
 3. SHELL: STEEL
 4. FEMALE HEX SCREW: BRASS

FINISH:
 1. SHELL: NICKEL PLATED OVER COPPER
 2. CONTACT: SELECTIVE GOLD PLATING

ENVIRONMENTS:
 1. OPERATING TEMPERATURE: -55°C TO +105°C

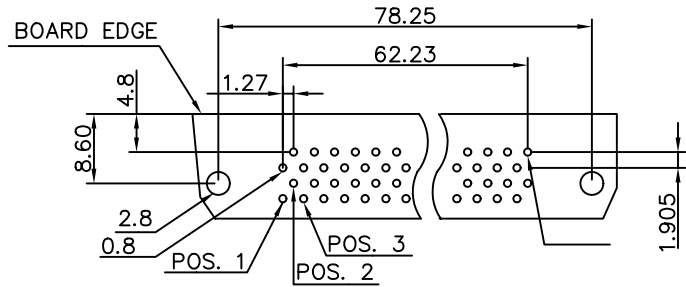
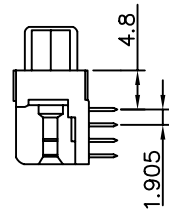
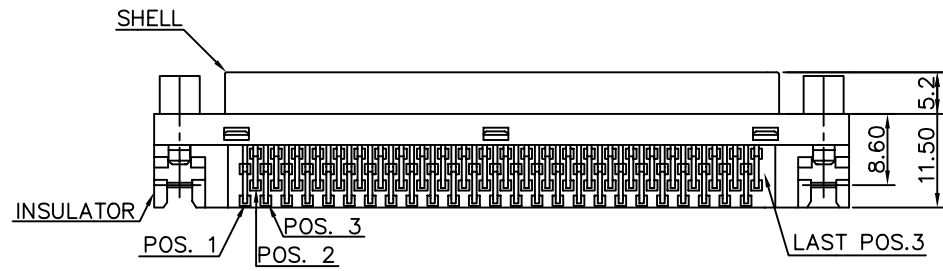

RECOMMENDED PC BOARD LAYOUT (PCB THICKNESS=1.60/0.062)

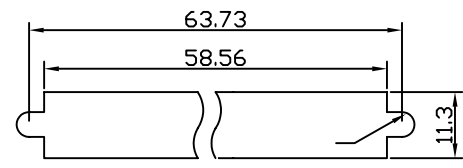

RECOMMENDED PANEL-FITTING DIMENSION
 (PANEL THICKNESS: Max.2.0/.078)



焯倫有限公司

PART NO. HPC-SRNJ-100		CHECKED BY CY		TOLERANCES ARE .X ± 0.2 .XX ± .XXX ± AWG	DESCRIP TION:			
DWG NO. HPC-SRNJ-100		DRAWING BY						
FILE NO.		PROJECTION		AREA	REVISIONS	HK	DATE	
UNIT / mm	SCALE 1:1							