

• **MATERIALS:(RoHS Compliant)**

Housing: Plastic Thermoplastic  
P.B.T UL94V-0 Black

Contacts: Phosphor Bronze Gold  
Selective Plated

Front Shell: Steel Nickel Plated Over Copper

• **ELECTRICAL CHARACTERISTICS:**

Contact Current Rating: 1 Amp

Dielectric Withstanding Voltage: 500V AC

Insulation Resistance: >500MΩ/Min

Contact Resistance: 35mΩ/Max

Operation Temperature: -55°C ~ +105°C

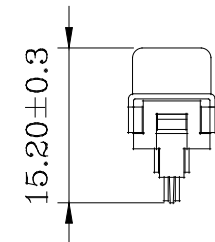
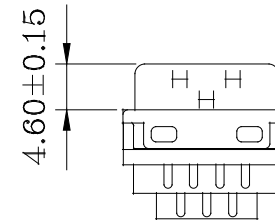
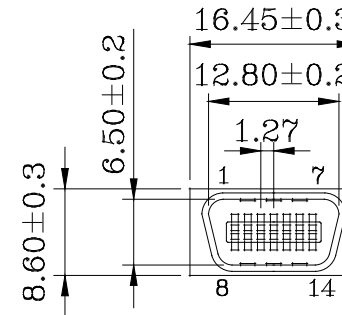

**RoHS Compliant**

TOLERANCES ARE

**MORETHANALL**  
PCB CONNECTORS  
Cable ASSEMBLIES

DRAWING BY CY

CHECKED BY GENIUS

UNIT / mm

SCALE 1:1

DATE

SIZE A4

PPOJECTION

X.±  
.X±  
.XX±  
.XXX±  
ANG±

照片框

**ORDER INFORMATION**

HPC-PM-014-LF  
SERIES | LEADFREE  
14 WAY  
MOLDED  
MALE

煜倫股份有限公司

www.morethanall.com

DESCRIPTION:1.27mm(.050") Ribbon 14Pos Cable Plug Connector Solder Molded Type