

Material:

1. Insulator: PBT+30% Glass Fiber(Meet UL94V-0).
2. Contact: Copper Alloy.
3. Contact Plated: Gold or Tin over Nickel Plated.
4. Shell: Steel with Nickel or Tin or Zinc Plated.

Specification:

1. Current Rating: 5 Amps.
2. Withstanding Voltage: AC 500V for 1 Minute.
3. Insulation Resistance: 1000MΩ Min. at DC 500V.
4. Contact Resistance: 15mΩ Max..
5. Operating Temperature: -40°C~+105°C.

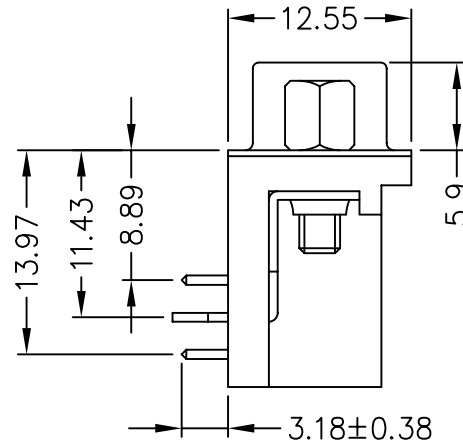
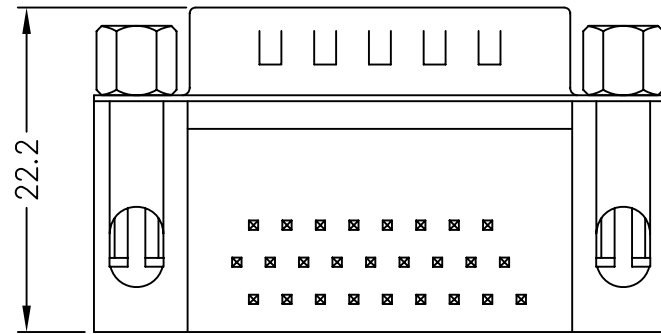

HDR-Px-xx-LF
LEADFREE
S: SEMI / GOLD
G: FULL / GOLD

RoHS Compliant

No. of Contacts	Dim. A	Dim. B	Dim. C	Dim. D	Dim. E
15	16.92	24.99	30.81	2.29	0.25
26	25.25	33.32	39.14	2.29	0.51
44	38.96	47.04	53.04	2.29	0.51
62	55.42	63.50	69.32	2.41	0.58



PART NO. HDR-Px-xx		CHECKED BY CY		TOLERANCES ARE		DESCRIPTION: Hi-Density D-Sub Right Angle Male Connector 8.89mm With Locking Screw Type				
DWG NO. HDR-Px-xx		DRAWING BY		.X ± 0.3 .XX ± 0.15 XXX ± AWG						
FILE NO.		PROJECTION		UNIT / mm		AREA	REVISIONS	HK	DATE	
SCALE 1:1										

焯倫股份有限公司