

REMARKS:

- 1. MATERIAL:
  - 1.1 HOUSING: HIGH TEMPERATURE THERMOPLASTIC UL 94V-0 RATED
  - 1.2 CONTACT: COPPER ALLOY
- 2. PLATING:
  - 2.1 CONTACT: GOLD PLATED OVER NICKEL ON CONTACT AREA AND 100u" MIN. TIN PLATED OVER NICKEL ON SOLDER TAILS
  - 2.2 SHELL: TIN PLATED OVER NICKEL OR NICKEL PLATED

HDMI-SLM-19-LF  
LEADFREE  
RoHS Compliant



PART NO. HDMI-SLM-19		CHECKED BY CY		TOLERANCES ARE .X ± 0.2 .XX ± .XXX ± AWG	DESCRIP TION: HDMI RECEPTACLE REVERSE DIP TYPE
DWG NO. HDMI-SLM-19		DRAWING BY			
FILE NO.		PROJECTION		AREA	REVISIONS
UNIT / mm	SCALE 1:1			HK	DATE

焯倫股份有限公司

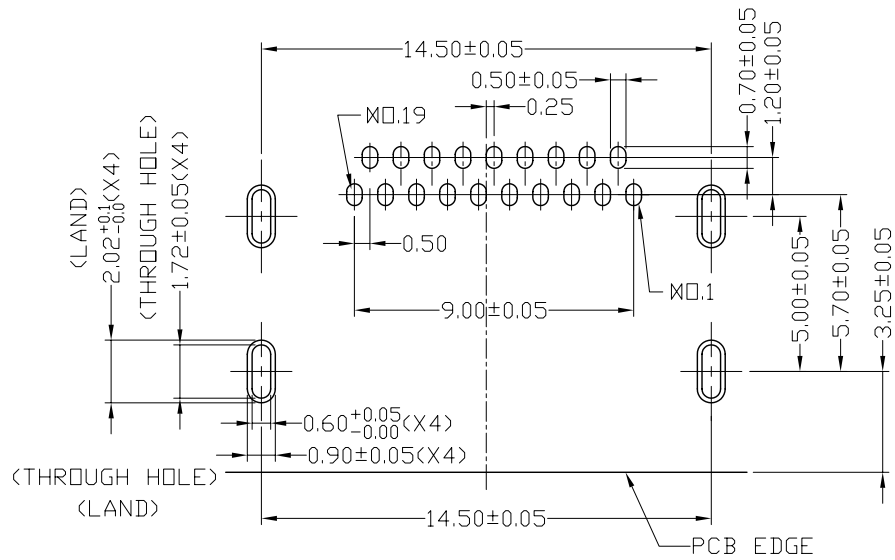

RECOMMENDED PCB LAYOUT (THICKNESS=1.4±0.15mm)

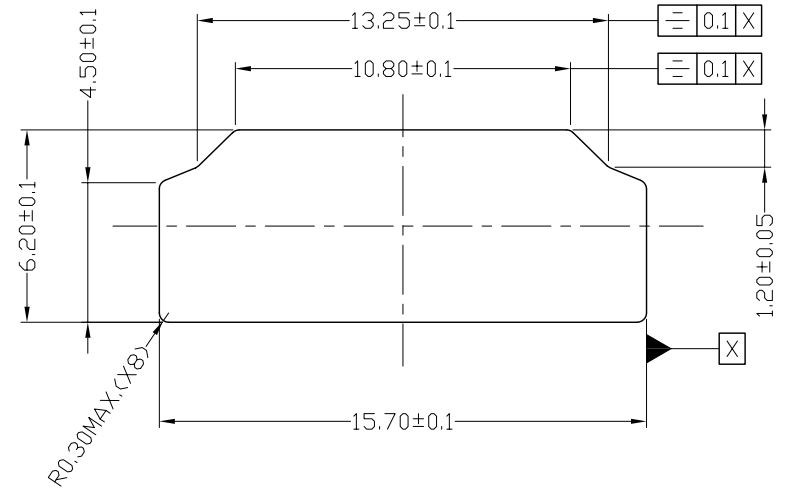

REFERENCE PANEL CUT OUT DIMENSION

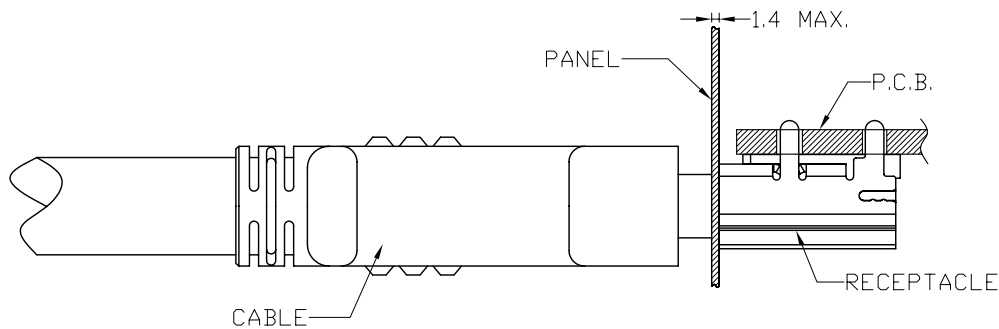

REFERENCE MOUNT DIMENSION

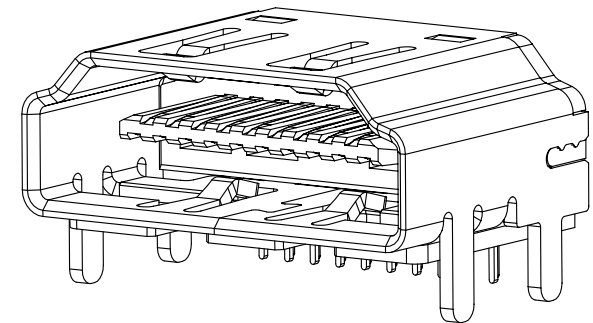

**MORETHANALL**  
CONNECTORS  
ASSEMBLIES

PART NO. HDMI-SLM-19

DWG NO. HDMI-SLM-19

FILE NO.

CHECKED BY CY

DRAWING BY

TOLERANCES ARE

.X ± 0.2

.XX ±

.XXX ±

AWG

DESCRIPTION:

焯倫股份有限公司

UNIT / mm

SCALE 1:1

PROJECTION

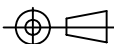

AREA

REVISIONS

HK

DATE