

SPECIFICATION

MATERIAL

Insulator: Thermal Plastic UL94V-0
 Contacts: Copper alloy
 Shell: Steel

CONTACT PLATING

Underplate: 50u" ~100u" Nickel
 Contact area: 1u" Selective gold
 Solder tails area: 100u" ~200u" Tin(Lead Free)

ELECTRICAL

Operation voltage: 250V Max.
 Current rating: 2.5 Amps Max.
 Contact resistance: 25 mohms initial
 Insulation resistance: 3000 Mohms min @ 500 VDC
 Dielectric withstanding voltage: 500 VAC / minute
 Temperature range: -55°C TO +105°C
 Mating cycles: 500 insertions

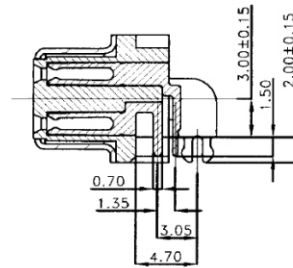
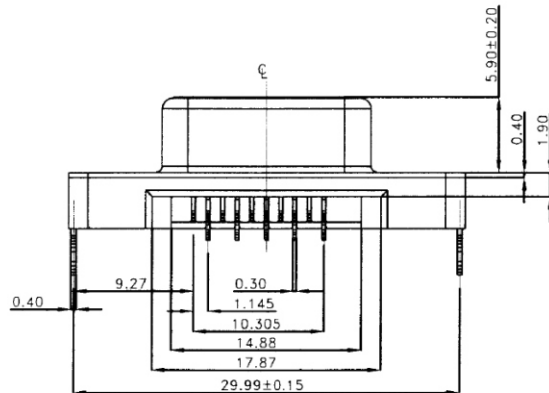

A-A SECTION

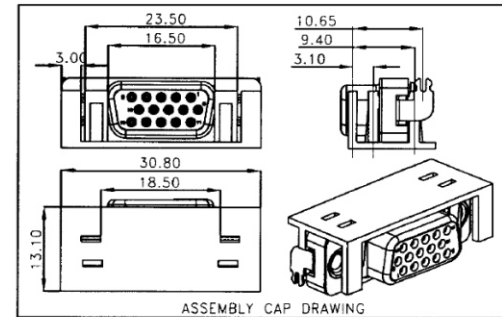

ASSEMBLY CAP DRAWING

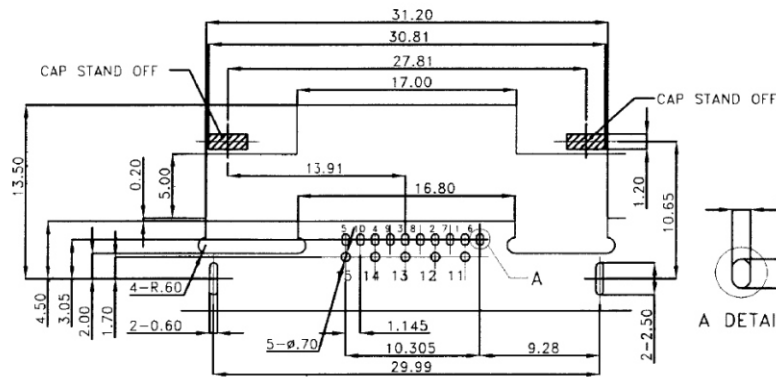

RECOMMENDED P.C.B LAYOUT (COMPONENT SIDE)
 THICKNESS:1.2mm GENERAL TOLERANCE:±0.05mm

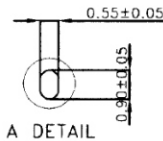

A DETAIL

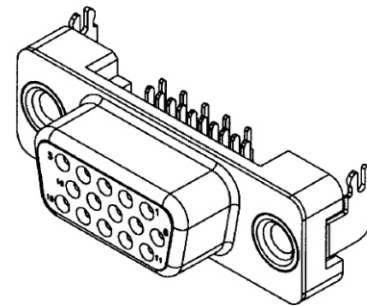

HDL15-SNC-15-LF
 LEADFREE
 CAP
 RoHS Compliant

MORETHANALL
 CONNECTORS
 ASSEMBLIES

PART NO. HDL15-SNC-15

DWG NO. HDL15-SNC-15

FILE NO.

CHECKED BY CY

DRAWING BY

TOLERANCES ARE

.X ± 0.2

.XX ±

.XXX ±

AWG

DESCRIPTION:

煜倫股份有限公司

UNIT / mm

SCALE 1:1

PROJECTION

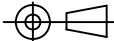

AREA

REVISIONS

HK

DATE