

A-A SECTION

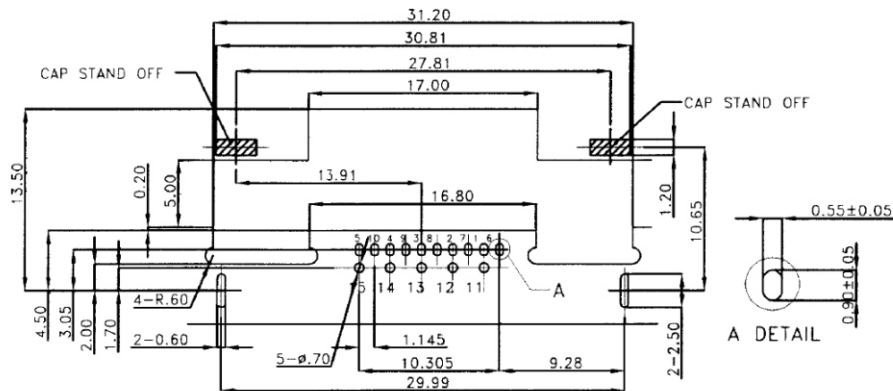

RECOMMENDED P.C.B LAYOUT (COMPONENT SIDE)
THICKNESS:1.2mm GENERAL TOLERANCE:±0.05mm

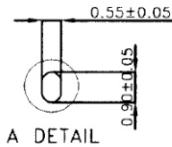

A DETAIL

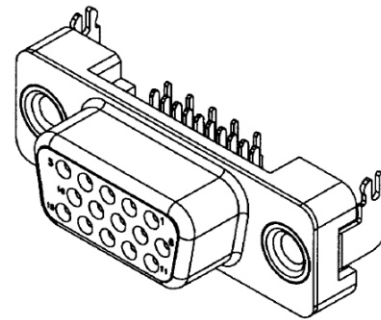

SPECIFICATION

MATERIAL

Insulator: Thermal Plastic UL94V-0

Contacts: Copper alloy

Shell: Steel

CONTACT PLATING

Underplate: 50u"~100u" Nickel

Contact area: 1u" Selective gold

Solder tails area: 100u"~200u" Tin(Lead Free)

ELECTRICAL

Operation voltage: 250V Max.

Current rating: 2.5 Amps Max.

Contact resistance: 25 mohms initial

Insulation resistance: 3000 Mohms min @ 500 VDC

Dielectric withstanding voltage: 500 VAC / minute

Temperature range: -55°C TO +105°C

Mating cycles: 500 insertions

HDL15-SN-15-LF
LEADFREE

RoHS Compliant

MORETHANALL
CONNECTORS
ASSEMBLIES

PART NO. HDL15-SN-15

DWG NO. HDL15-SN-15

CHECKED BY CY

TOLERANCES ARE

DESCRIPTION:

FILE NO.

DRAWING BY

.X ± 0.2

.XX ±

.XXX ±

AWG

AREA

REVISIONS

HK

DATE

焯倫股份有限公司

UNIT / mm

SCALE 1:1

PROJECTION

