

MATERIAL
Contact Pin : Brass

SPECIFICATION
Current Rate : 3 AMP
Insulation Resistance : 5000MΩMin. at DC 500V
Contact Resistance : 20mΩMax. at DC 100mA
Dielectric Voltage : AC 500V for one minute

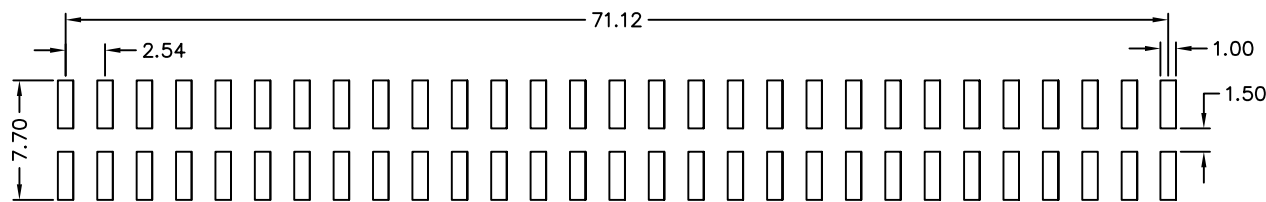
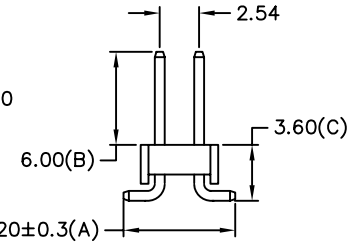
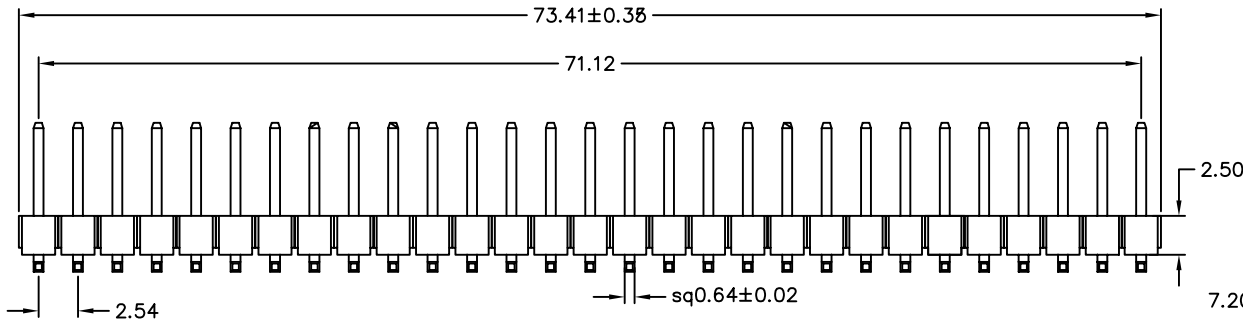

H-V36X-2X29-LF
LEADFREE
RoHS Compliant

Recommended P.C.B Layout

MORETHANALL
CONNECTORS
ASSEMBLIES

煜倫股份有限公司

PART NO. H-V36X-2X29		CHECKED BY CY	TOLERANCES ARE .X± .XX± .XXX± AWG	DESCRIPTION: PIN HEADER 2.54*2.54mm SMT S/T TYPE	AREA	REVISIONS	HK	DATE
DWG NO. H-V36X-2X29								
FILE NO.		PROJECTION						
UNIT / mm	SCALE 1:1							