

RECOMMENDED P.C.B LAYOUT

CONTACTS
1X41
1X42
1X43
1X44
1X45
1X46
1X47
1X48
1X49
1X50

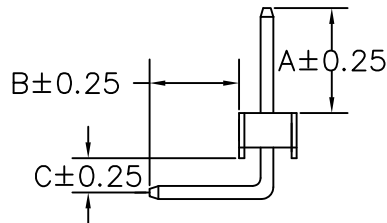
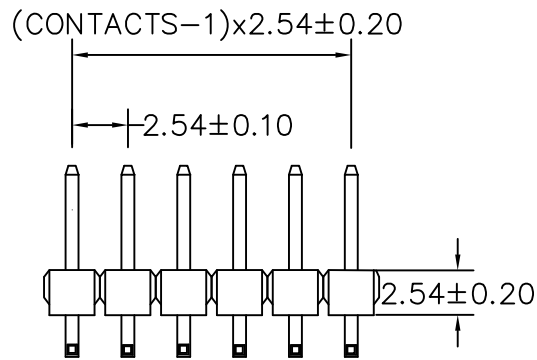

**MATERIAL**  
 HOUSING : 9T,UL94V-0  
 CONTACT : COPPER ALLOYS  
 PLATED : TIN-PLATED  
 COLOR : BLACK

**SPECIFICATION**  
 CURRENT: 3A  
 OPERATING TEMPERATURE: -55°C TO +105°C  
 CONTACT RESISTANCE : 20 MILLIOHMS MAX  
 INSULATION RESISTANCE : 1000 MEGAOHMS MIN  
 WITHSTANDING VOLTAGE : 1000 V AC/minute

A: 3.00 mm B: 2.30 mm C: 1.50 mm

RoHS Compliant

TOLERANCES ARE

**MORETHANALL**  
 PCB CONNECTORS  
 Cable ASSEMBLIES

DRAWING BY CY

X. ±  
 .X ± 0.38

CHECKED BY GENIUS

.XX ± 0.25

UNIT / mm

SCALE 1 : 1

.XXX ±

ANG ± 5°

DATE

SIZE A4

P PROJECTION

照片框

ORDER INFORMATION

H-RL2515030023T-1Xxx-LF

SERIES | | | | | LEADFREE

DIP 90° | | | | | 1X41:41WAY

LOW | | | | | 1X50:50WAY

BASE 2.54mm | | | | | TIN

RA 1.5mm | | | | | DIP 2.3mm

CONTACT 3.0mm

煜倫股份有限公司

www.morethanall.com

DESCRIPTION: