

RECOMMENDED P.C.B LAYOUT

**MATERIAL**  
 HOUSING : NY6T,UL94V-0  
 CONTACT : COPPER ALLOYS  
 PLATED : GOLD FLASH  
 COLOR : BLACK

**SPECIFICATION**

CURRENT: 3A  
 OPERATING TEMPERATURE: -55°C TO +105°C  
 CONTACT RESISTANCE : 20 MILLIOHMS MAX  
 INSULATION RESISTANCE : 1000 MEGAOHMS MIN  
 WITHSTANDING VOLTAGE: AC 1000V RMS

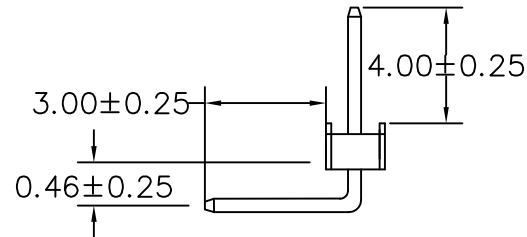
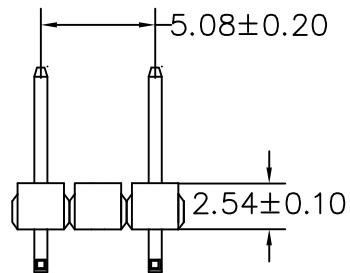

**MORETHANALL**  
 PCB CONNECTORS  
 Cable ASSEMBLIES  
 煜倫股份有限公司  
 www.morethanall.com

RoHS Compliant

DRAWING BY CY  
 CHECKED BY GENIUS  
 UNIT / mm SCALE 1:1  
 DATE  
 SIZE A4

TOLERANCES ARE

X. ±  
 .X ± 0.38  
 .XX ± 0.25  
 .XXX ±  
 ANG ± 5°

照片框

ORDER INFORMATION

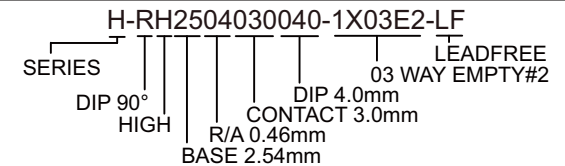

DESCRIPTION: PIN HEADER 2.54 90° H:2.54